



Sedna

Catalogue 2020



se.com

Life Is On

Schneider
Electric



Content

| | |
|---|-----------|
| Introduction | 4 |
| Mechanisms without cover frame..... | 18 |
| Switches and Push-buttons | 18 |
| Dimmers..... | 24 |
| Thermostats | 25 |
| USB chargers | 25 |
| Socket-outlets..... | 26 |
| Data and Telephone outlets..... | 27 |
| Antenna outlets | 29 |
| Other functions..... | 31 |
| Mechanisms with cover frame | 32 |
| Boxes | 33 |
| Cover frames..... | 34 |
| Technical information..... | 36 |
| Switches and Push-buttons connection diagrams | 36 |
| Rotary dimmers | 37 |
| Thermostat | 43 |
| USB chargers | 46 |
| Key card switches..... | 47 |
| Data and Telephone outlets | 48 |
| Antenna outlets | 51 |
| Surface mounting Boxes..... | 54 |
| Cover frames..... | 55 |
| Reference number overview | 56 |

Introduction

Sedna is pure design

Offer to your customers an original alternative to traditional white switches and sockets. With its streamlined design and elegant colors, the Sedna range will give you the edge you are looking for.



Flat design,
8 mm depth

Colors

With 8 colored frames and 6 colored inserts available, you can offer a rich and diverse product range with a minimum of stock management required.

8 colored frames



6 colored inserts

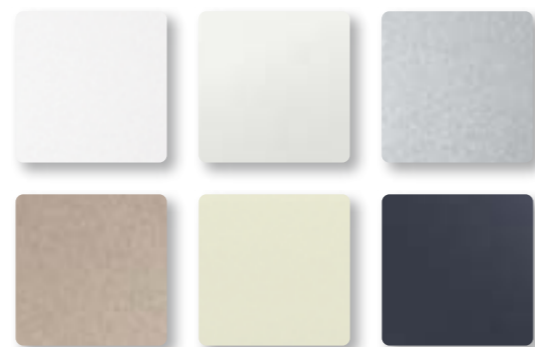

Functions

Sedna offers full functionality of a flexible switch program. Whether switches or sockets, dimmers, thermostats or movement detectors, the Sedna range leaves nothing to be desired and meets all requirements on a modern electrical installation.



1-way switch



1-way switch with pilot lamp



2-circuit switch with pilot lamp



Push-button with pilot lamp



USB charger



Socket outlet with shutters



Socket outlet with shutters



Roller blind control switch



Movement detector



Rotary dimmer



Room thermostat



Rotary push-button dimmer



Tel + data outlet



TV/R/SAT outlet



Movement detector



Socket-outlet with lid, IP44



RJ45



More comfort for your customers...

Combining comfort, lighting and heating control, Sedna has it all. The Advanced functions can help to simplify your customers' lives and demonstrate the added value of your business.

Comfort at the fingertips

The home beats to the rhythm of the occupants' personal routine and needs:

- heating systems programmed to offer optimum comfort from the moment residents step through the door;
- light dimmers provide just the right level of brightness;
- roller blinds can be controlled with one flick of a switch.

A safe environment

Sometimes, all it takes is one detail to make the home safer. All Sedna socket outlets come with shutters to prevent accidents. Motion detectors can also provide automatic lighting so that occupants can move around safely and easily during the night.

All the connections they need

Offer your customers a powerful network to connect to the internet or watch television anywhere in the home.



Light control

Advanced light control functions increase comfort and safety: At night, the illuminated switch will guide you in corridors or entrances.

Dimmer

Dim your lights to a pleasant light level.

Movement detector

Automatically switch on and off depending on presence detection and the light condition (light sensor).

Roller blinds control

For protection from sun, cold and unwanted attention or burglary – controlled with one flick of a switch.

Temperature control

With a room thermostat the temperature permanently stays comfortable, but also helps to control energy costs.

Connectivity

Internet, PC, TV, telephones, network technology and multimedia functions for a modern life:

- RJ45
- TV/R/SAT

IP44

Socket-outlets and switches with IP44 frames are perfect for use in damp rooms like cellars, garages, workshops, production facilities and outdoors.

Socket-outlets

Socket outlets with shutters protect your customer from touching the metal parts under tension.





The new generation of inserts that are so easy to install

Do you install switches and socket-outlets on a regular basis? Then we've got good news for you! We've come up with a new generation of socket-outlets and switch inserts that make installation simple, fast and convenient.

Designed to meet your needs

At Schneider Electric, we listen to your feedback and we understand what you need to make your day-to-day work run more smoothly. This is why we've recently improved the quality and functionality of inserts for the Sedna range. The updated Sedna range now features reliable screwless socket-outlets, high quality claws, secure robustness as well as additional, smart functions that provide an efficient installation workflow for each step: for connecting, aligning, fastening, fixing and testing! Installation has never been so easy, fast and convenient.

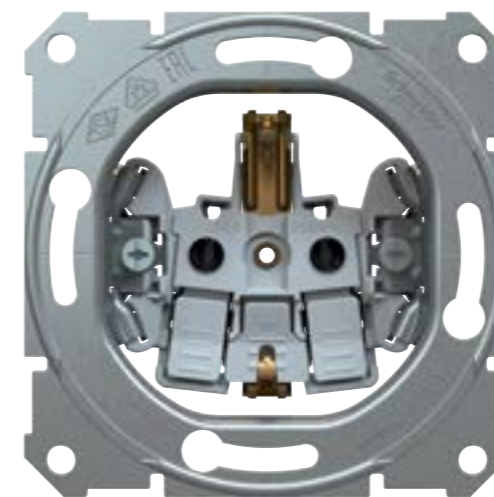

New socket-outlet with screwless terminal

We understand that electricians appreciate the simple, fast and convenient installation of flush-mounted inserts. That's why we've come up with screwless socket-outlet terminals - which make wiring easy, quick and reliable.

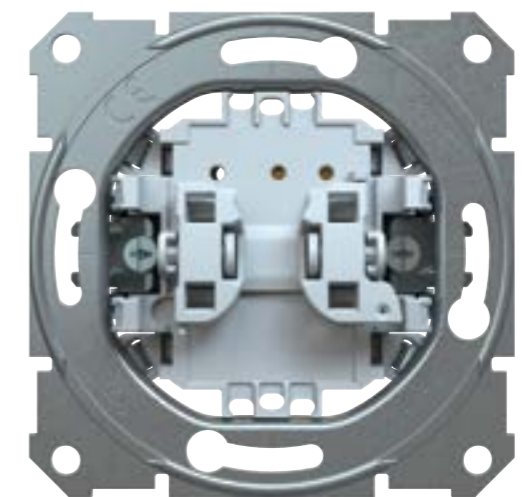

New switch and push-button insert with improved features!

Newly designed switch and push-button inserts let you connect more easily, align and fasten more quickly, test more conveniently, and effortlessly add additional functions.

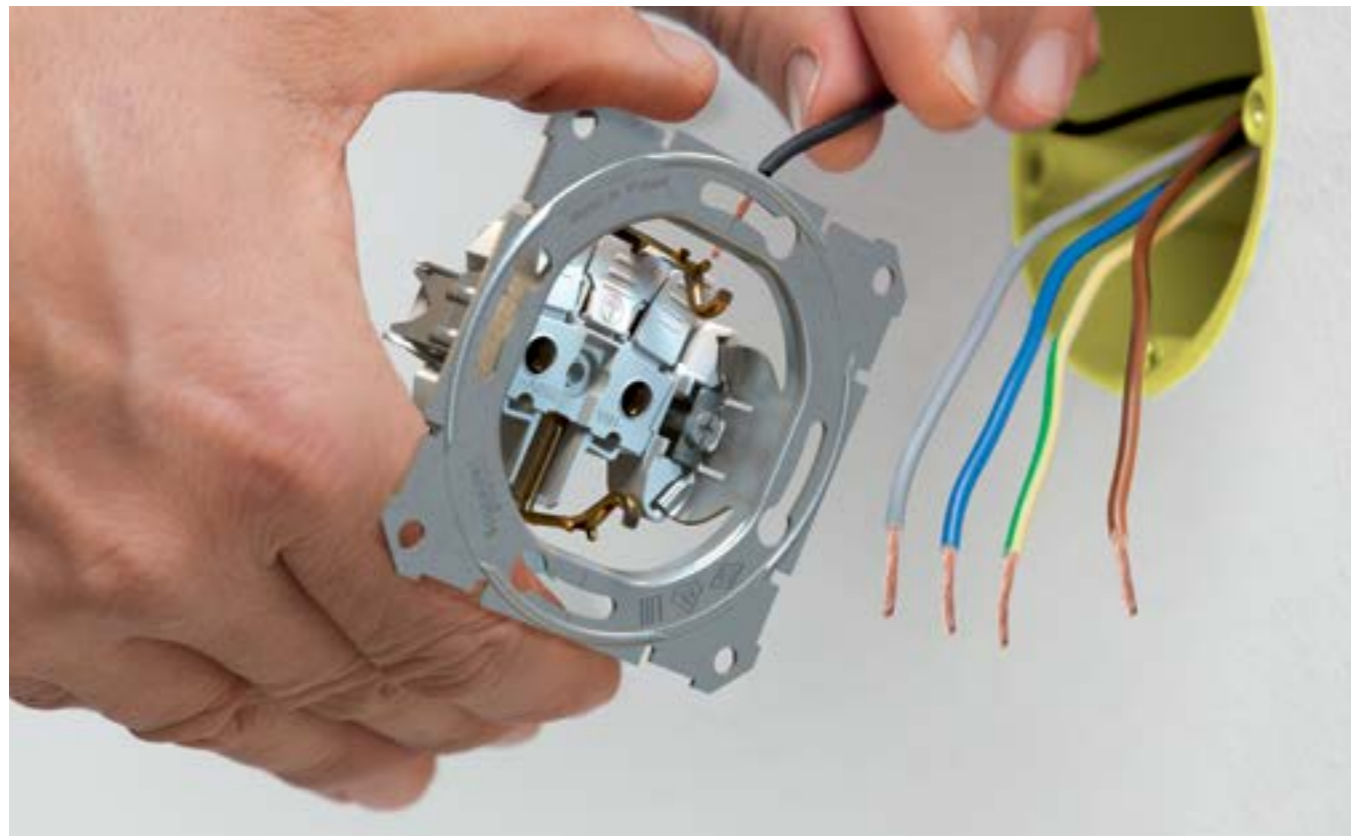

Socket-outlet with screwless terminal

The new Sedna socket-outlet features a screwless terminal – which has been redesigned, to ensure a simple, fast and reliable installation.

NEW!

- + Time saving
- + Reliable
- + Screwless

Easy-to-use release buttons

Release buttons are easy to access. Large in size, the release buttons reduce surface pressure on your finger. Improved mechanics now make the release of the fastened wires even smoother.

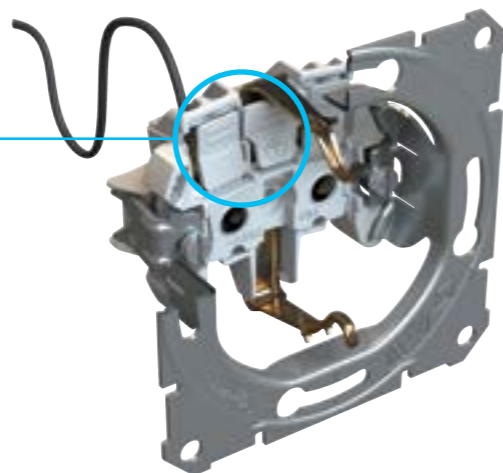

Switch and push-button inserts

It only takes the slightest glance to notice that numerous features have been optimized to make your installation workflow more efficient.

Release buttons

New button mechanics make the release of fastened wires easier and smoother than ever.

Conical cable entries

Conical cable entries make it easier to feed the connection wires into the terminal blocks. The terminal shapes are guiding wires into the right place.

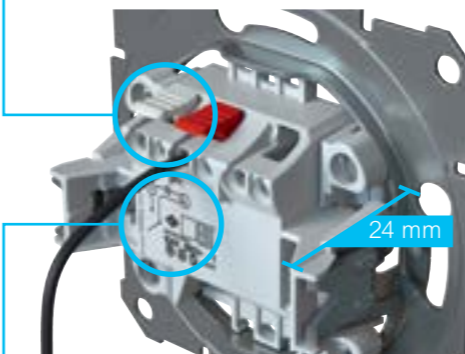

Low mounting depth

A low mounting depth of 24 mm provides more freedom of movement for the insert during the wiring process.

Wiring diagram

The wiring diagram is printed on the rear of the switch and push-button base. Here, the switch type and connection options are clearly visible.



Convenient front-side testing

Checkpoints allow convenient testing of all functions and measuring from the front – and there's no need to disassemble the switch.

Lighting modules

Whether as a first installation or as a renovation, you can now add LED lighting modules and rockers to Sedna push-button and switch inserts, without having to remove the inserts.

- LED module indication light, red
- LED module orientation light, blue
- LED light modul for hotel key card switch, blue



Improved!

- + new features
- + easy-to-operate functions
- = faster installation!

For a simple and fast installation

When it comes to aligning and fastening, our innovative new features will make all the difference to your daily installation projects.

Innovative new functions that offer a smooth installation workflow

The new Sedna inserts feature robust fixing frames as well as clear alignment markings, which make switch and socket-outlet insert installation quick and easy – even on uneven walls. Cleverly designed new claws also contribute to an installation procedure that is extremely simple and fast.

Screw slots

The screw slots allow rotation of the insert in either direction, to correct installation boxes that have been misaligned. These slots are a perfect fit for flush mounted box standard screws, so fixing is now even easier and even more reliable.

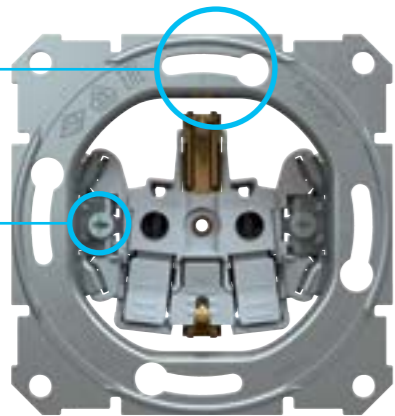

Claw-return function

The claw-return function makes mounting and realignment easier than ever.

Protected claws

Pre-installation, the claws are fully retracted in the sides of the housing. This means that the claws cannot catch during the installation process, which minimizes the risk of injury. If not required, then the claws remain retracted, which makes for an even easier installation.

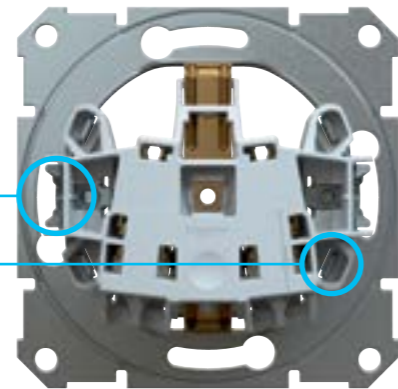

4 point fixation

Insert and fixing frame are very robust thanks to the strong and reliable 4 point fixation.

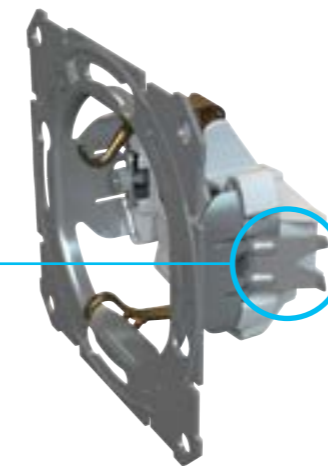

Claws for perfect alignment

Thanks to its redesigned mechanism, the claws extend out straight and smoothly, ensuring a perfect alignment to the wall boxes during assembly. The claws ensure that the insert fixes stable in the box.

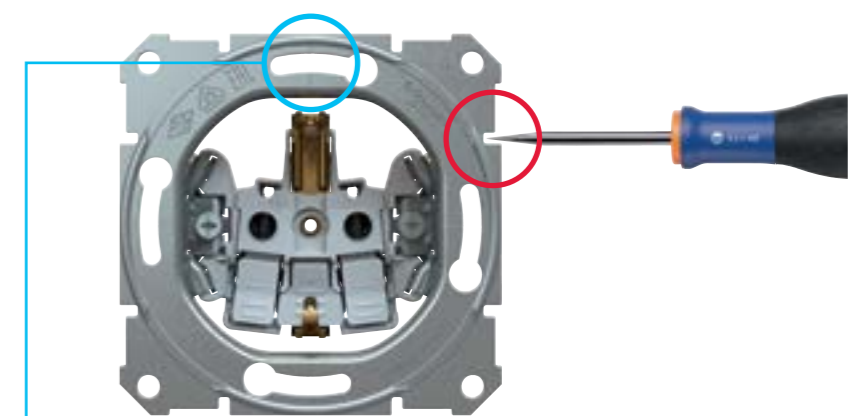

Alignment markings and slots

Clear alignment markings and screwdriver slots make it easy to adjust inserts and give a clear orientation, to ensure perfect alignment of multiple inserts.



New frames for all conditions

The new Sedna switches and push-buttons provide a new mechanism, that allows easy assembly of frames, inserts and rockers in installation process.

Optimized for your convenience!

With the new "one easy click" mechanism, the frame and the insert can be connected very simply. The optimized interface of both parts allow a simple plug-in and the frame already fits perfectly on the insert. Completely new and practical: No adapter is required to mount the rocker.

No adapter necessary



The new "one easy click" interlocking mechanism

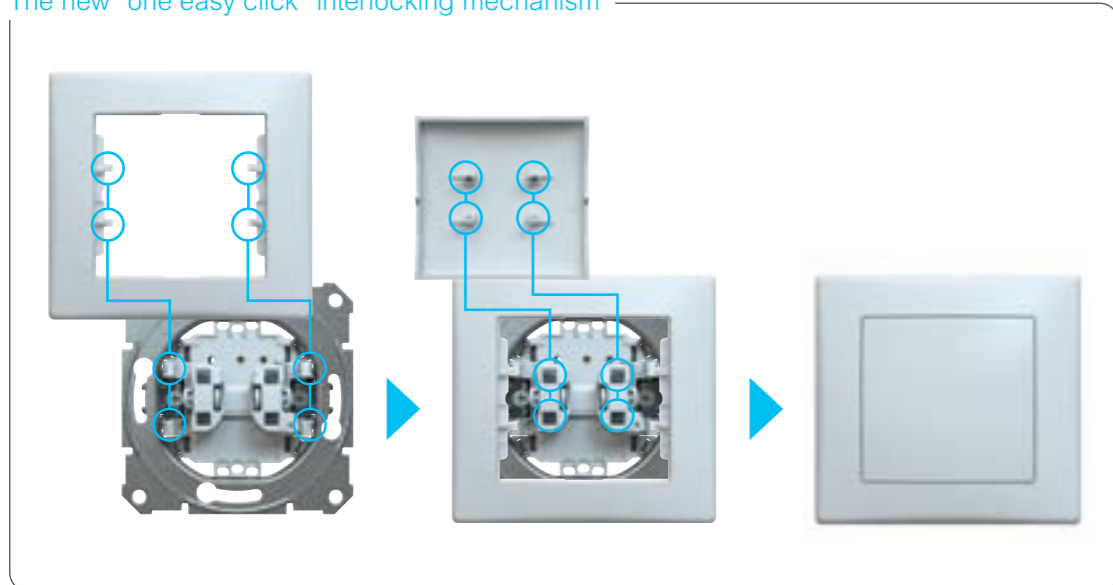

Compatibility means flexibility

Backwards and forwards compatibility gives you the ultimate in installation flexibility, to satisfy your customers' short- and long-term needs.

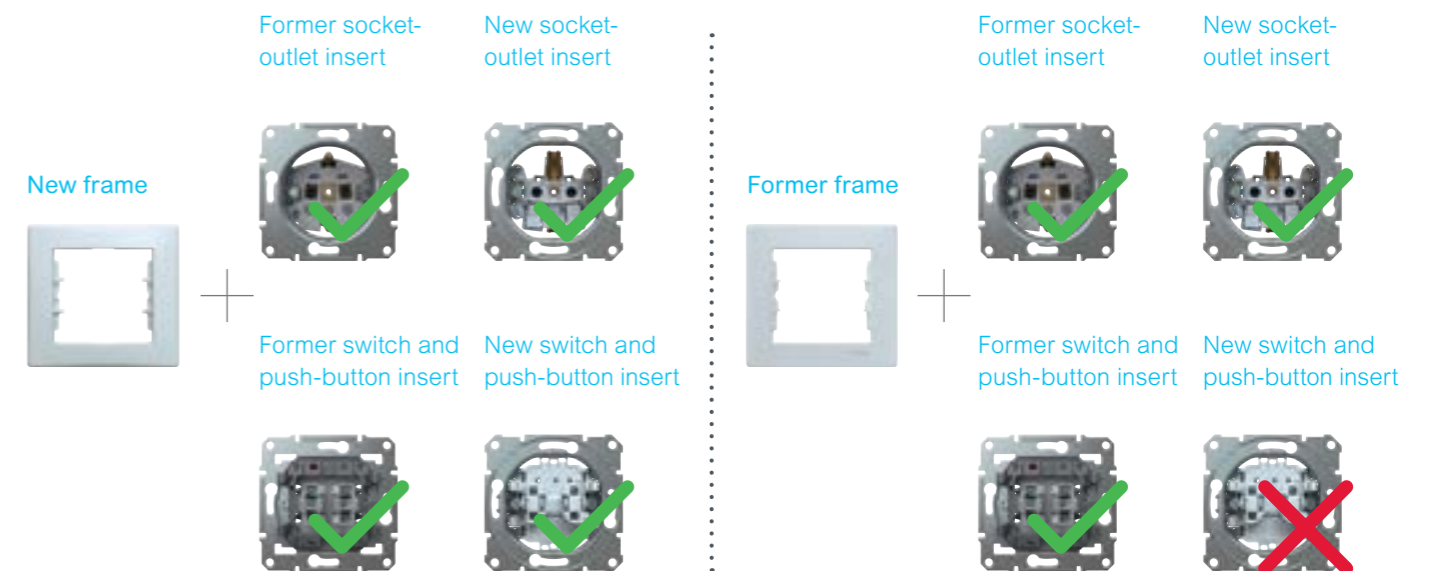

New IP44 frames

In wet areas or conditions, switches and socket-outlets must conform to strict regulatory standards – which state that they must be weatherproof and must also protect against the threat of moisture. The new Sedna IP44 frames are available in 1-3 gang, horizontal, and come in a complete range of colors. Thanks to the featured membrane seals, these frames meet the IP44 standard for Sedna switches, push-buttons and socket-outlets.

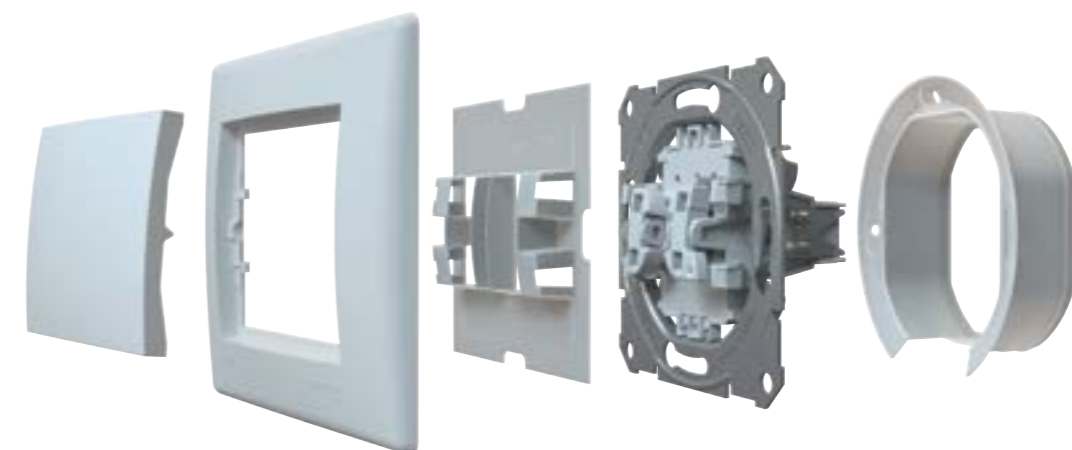

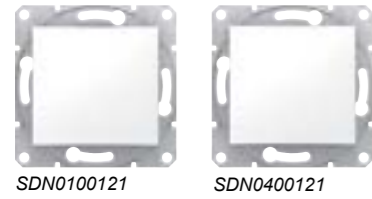

Switches

10 AX - 250 V AC switches

| Colour | 1-way screwless | 2-way screwless |
|------------------------|-----------------|-----------------|
| white | SDN0100121 | SDN0400121 |
| cream | SDN0100123 | SDN0400123 |
| aluminium | SDN0100160 | SDN0400160 |
| titanium | SDN0100168 | SDN0400168 |
| beige | SDN0100147 | SDN0400147 |
| graphite | SDN0100170 | SDN0400170 |
| Intermediate screwless | | |
| white | SDN0500121 | |
| cream | SDN0500123 | |
| aluminium | SDN0500160 | |
| titanium | SDN0500168 | |
| beige | SDN0500147 | |
| graphite | SDN0500170 | |
| Double 2-way screwless | | |
| white | SDN0600121 | |
| cream | SDN0600123 | |
| aluminium | SDN0600160 | |
| titanium | SDN0600168 | |
| beige | SDN0600147 | |
| graphite | SDN0600170 | |
| 2-circuit screwless | | |
| white | SDN0300121 | |
| cream | SDN0300123 | |
| aluminium | SDN0300160 | |
| titanium | SDN0300168 | |
| beige | SDN0300147 | |
| graphite | SDN0300170 | |
| 3-circuit screwless | | |
| white | SDN0300621 | |
| cream | SDN0300623 | |
| aluminium | SDN0300660 | |
| beige | SDN0300647 | |
| graphite | SDN0300670 | |
| 2-pole screwless | | |
| white | SDN0200121 | |
| cream | SDN0200123 | |
| aluminium | SDN0200160 | |
| titanium | SDN0200168 | |
| beige | SDN0200147 | |
| graphite | SDN0200170 | |

Characteristics

- Maximum load for self ballasted lamps (LED, CFL, etc.):
 - 10 AX - 250 V AC switches: 100 W
 - 16 AX - 250 V AC switches: 200 W



16 AX - 250 V AC switches

| Colour | 2-way screwless |
|------------------|-----------------|
| white | SDN0400421 |
| cream | SDN0400423 |
| aluminium | SDN0400460 |
| titanium | SDN0400468 |
| beige | SDN0400447 |
| graphite | SDN0400470 |
| 2-pole screwless | |
| white | SDN0200221 |
| cream | SDN0200223 |
| aluminium | SDN0200260 |
| titanium | SDN0200268 |
| beige | SDN0200247 |
| graphite | SDN0200270 |

IP44 10 AX - 250 V AC switches

| Colour | 1-way screwless | 2-way screwless |
|------------------------|-----------------|-----------------|
| white | SDN0100321 | SDN0400521 |
| cream | SDN0100323 | SDN0400523 |
| aluminium | SDN0100360 | SDN0400560 |
| titanium | SDN0100368 | SDN0400568 |
| beige | SDN0100347 | SDN0400547 |
| graphite | SDN0100370 | SDN0400570 |
| Intermediate screwless | | |
| white | SDN0500321 | |
| cream | SDN0500323 | |
| aluminium | SDN0500360 | |
| titanium | SDN0500368 | |
| beige | SDN0500347 | |
| graphite | SDN0500370 | |
| 2-circuit screwless | | |
| white | SDN0300421 | |
| cream | SDN0300423 | |
| aluminium | SDN0300460 | |
| titanium | SDN0300468 | |
| beige | SDN0300447 | |
| graphite | SDN0300470 | |
| 2-pole screwless | | |
| white | SDN0200321 | |
| cream | SDN0200323 | |
| aluminium | SDN0200360 | |
| titanium | SDN0200368 | |
| beige | SDN0200347 | |
| graphite | SDN0200370 | |

Characteristics

- Maximum load for self ballasted lamps (LED, CFL, etc.):
 - 10 AX - 250 V AC switches: 100 W
 - 16 AX - 250 V AC switches: 200 W

Switches (cont'd)

10 AX - 250 V AC switches with blue locator lamp

| 1-way screwless | | 2-way screwless | |
|------------------------------------|------------|------------------------------------|------------|
| | | | |
| Colour | | Colour | |
| <input type="checkbox"/> white | SDN1400121 | <input type="checkbox"/> white | SDN1500121 |
| <input type="checkbox"/> cream | SDN1400123 | <input type="checkbox"/> cream | SDN1500123 |
| <input type="checkbox"/> aluminium | SDN1400160 | <input type="checkbox"/> aluminium | SDN1500160 |
| <input type="checkbox"/> titanium | SDN1400168 | <input type="checkbox"/> titanium | SDN1500168 |
| <input type="checkbox"/> beige | SDN1400147 | <input type="checkbox"/> beige | SDN1500147 |
| <input type="checkbox"/> graphite | SDN1400170 | <input type="checkbox"/> graphite | SDN1500170 |

| Intermediate screwless | |
|------------------------------------|------------|
| | |
| Colour | |
| <input type="checkbox"/> white | SDN0501121 |
| <input type="checkbox"/> cream | SDN0501123 |
| <input type="checkbox"/> aluminium | SDN0501160 |
| <input type="checkbox"/> titanium | SDN0501168 |
| <input type="checkbox"/> beige | SDN0501147 |
| <input type="checkbox"/> graphite | SDN0501170 |

| 2-circuit screwless | |
|------------------------------------|------------|
| | |
| Colour | |
| <input type="checkbox"/> white | SDN0300321 |
| <input type="checkbox"/> cream | SDN0300323 |
| <input type="checkbox"/> aluminium | SDN0300360 |
| <input type="checkbox"/> titanium | SDN0300368 |
| <input type="checkbox"/> beige | SDN0300347 |
| <input type="checkbox"/> graphite | SDN0300370 |

10 AX - 250 V AC switches with red indicator lamp

| 1-way screwless | | 2-way screwless | |
|------------------------------------|------------|-----------------------------------|------------|
| | | | |
| Colour | | Colour | |
| <input type="checkbox"/> white | SDN0400321 | <input type="checkbox"/> white | SDN0401121 |
| <input type="checkbox"/> cream | SDN0400323 | | |
| <input type="checkbox"/> aluminium | SDN0400360 | | |
| <input type="checkbox"/> titanium | SDN0400368 | | |
| <input type="checkbox"/> beige | SDN0400347 | <input type="checkbox"/> beige | SDN0401147 |
| <input type="checkbox"/> graphite | SDN0400370 | <input type="checkbox"/> graphite | |

| 2-pole screwless | |
|------------------------------------|------------|
| | |
| Colour | |
| <input type="checkbox"/> white | SDN0201121 |
| <input type="checkbox"/> cream | SDN0201123 |
| <input type="checkbox"/> aluminium | SDN0201160 |
| <input type="checkbox"/> titanium | SDN0201168 |
| <input type="checkbox"/> beige | SDN0201147 |
| <input type="checkbox"/> graphite | SDN0201170 |

| Characteristics |
|---|
| <ul style="list-style-type: none"> Maximum load for self ballasted lamps (LED, CFL, etc.): 10 AX - 250 V AC switches: 100 W 16 AX - 250 V AC switches: 200 W |

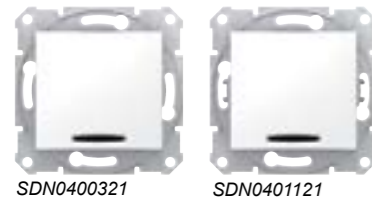
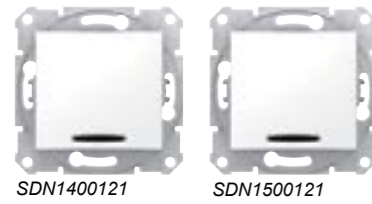

16 AX - 250 V AC switches with blue locator lamp

| 2-way screwless | |
|------------------------------------|------------|
| | |
| Colour | |
| <input type="checkbox"/> white | SDN1500221 |
| <input type="checkbox"/> cream | SDN1500223 |
| <input type="checkbox"/> aluminium | SDN1500260 |
| <input type="checkbox"/> titanium | SDN1500268 |
| <input type="checkbox"/> beige | SDN1500247 |
| <input type="checkbox"/> graphite | SDN1500270 |

16 AX - 250 V AC switches with red indicator lamp

| 2-pole screwless | |
|--------------------------------|------------|
| | |
| Colour | |
| <input type="checkbox"/> white | SDN0201221 |
| <input type="checkbox"/> beige | SDN0201247 |

10 AX - 250 V AC key card switch

| Mechanical, screwless | |
|------------------------------------|------------|
| | |
| Colour | |
| <input type="checkbox"/> white | SDN1900121 |
| <input type="checkbox"/> cream | SDN1900123 |
| <input type="checkbox"/> aluminium | SDN1900160 |
| <input type="checkbox"/> titanium | SDN1900168 |
| <input type="checkbox"/> beige | SDN1900147 |
| <input type="checkbox"/> graphite | SDN1900170 |

Roller blinds and shutters controls

| 10 AX - 250 V AC switch | 10 A - 250 V AC push-button |
|------------------------------------|-------------------------------|
| | |
| With electric lock, screwless | With electric lock, screwless |
| Colour | Colour |
| <input type="checkbox"/> white | SDN1300321 |
| <input type="checkbox"/> cream | SDN1300323 |
| <input type="checkbox"/> aluminium | SDN1300360 |
| <input type="checkbox"/> titanium | SDN1300368 |
| <input type="checkbox"/> beige | SDN1300347 |
| <input type="checkbox"/> graphite | SDN1300370 |
| | SDN1300121 |
| | SDN1300123 |
| | SDN1300160 |
| | SDN1300168 |
| | SDN1300147 |
| | SDN1300170 |

Cord push-buttons

| 10 A - 250 V AC | |
|--------------------------------|---------------------------|
| Screwless with cord | |
| | |
| Colour | |
| <input type="checkbox"/> white | SDN1200121 |
| <input type="checkbox"/> cream | SDN1200123 |
| | Cord length: 200 cm ±5 cm |

| Characteristics |
|---|
| <ul style="list-style-type: none"> Maximum load for self ballasted lamps (LED, CFL, etc.): 10 AX - 250 V AC switches: 100 W 16 AX - 250 V AC switches: 200 W |

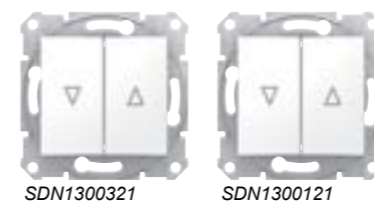

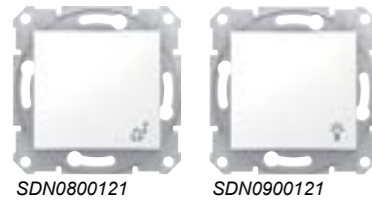
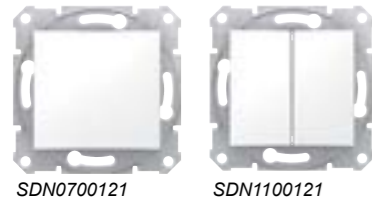

Push-buttons

10 A - 250 V AC push-buttons

| Colour | 1-way, screwless | Double-1-way, screwless |
|-----------|------------------------------------|-------------------------------------|
| white | SDN0700121 | SDN1100121 |
| cream | SDN0700123 | SDN1100123 |
| aluminium | SDN0700160 | SDN1100160 |
| titanium | SDN0700168 | SDN1100168 |
| beige | SDN0700147 | |
| graphite | SDN0700170 | SDN1100170 |
| Colour | 1-way, with bell symbol, screwless | 1-way, with light symbol, screwless |
| white | SDN0800121 | SDN0900121 |
| cream | SDN0800123 | SDN0900123 |
| aluminium | SDN0800160 | SDN0900160 |
| titanium | SDN0800168 | SDN0900168 |
| beige | SDN0800147 | SDN0900147 |
| graphite | SDN0800170 | SDN0900170 |
| Colour | 2-way screwless | |
| white | SDN0420121 | |
| cream | SDN0420123 | |
| aluminium | SDN0420160 | |
| titanium | SDN0420168 | |
| beige | SDN0420147 | |
| graphite | SDN0420170 | |

IP44 10 A - 250 V AC push-buttons

| Colour | 1-way, with bell symbol, screwless | 1-way, with light symbol, screwless |
|-----------|------------------------------------|-------------------------------------|
| white | SDN0800321 | SDN0900321 |
| cream | SDN0800323 | SDN0900323 |
| aluminium | SDN0800360 | SDN0900360 |
| titanium | SDN0800368 | SDN0900368 |
| beige | SDN0800347 | SDN0900347 |
| graphite | SDN0800370 | SDN0900370 |



10 A - 250 V AC push-buttons with blue locator lamp

| Colour | 1-way, screwless | |
|-----------|-------------------------------------|-------------------------------------|
| white | SDN1600121 | |
| cream | SDN1600123 | |
| aluminium | SDN1600160 | |
| titanium | SDN1600168 | |
| beige | SDN1600147 | |
| graphite | SDN1600170 | |
| Colour | 2-way, screwless | |
| white | SDN1520121 | |
| cream | SDN1520123 | |
| aluminium | SDN1520160 | |
| titanium | SDN1520168 | |
| beige | SDN1520147 | |
| graphite | SDN1520170 | |
| Colour | 1-way, with bell symbol, screwless | 1-way, with light symbol, screwless |
| white | SDN1600421 | SDN1800121 |
| cream | SDN1600423 | SDN1800123 |
| aluminium | SDN1600460 | SDN1800160 |
| titanium | SDN1600468 | SDN1800168 |
| beige | SDN1600447 | SDN1800147 |
| graphite | SDN1600470 | SDN1800170 |
| Colour | 1-way, with label holder, screwless | |
| white | SDN1600321 | |
| cream | SDN1600323 | |
| aluminium | SDN1600360 | |
| titanium | SDN1600368 | |
| beige | SDN1600347 | |
| graphite | SDN1600370 | |

10 A - 12 V AC push-buttons with blue locator lamp

| Colour | 1-way, with bell symbol, screwless | |
|-----------|-------------------------------------|--|
| white | SDN1700121 | |
| cream | SDN1700123 | |
| aluminium | SDN1700160 | |
| titanium | SDN1700168 | |
| beige | SDN1700147 | |
| graphite | SDN1700170 | |
| Colour | 1-way, with label holder, screwless | |
| white | SDN1700421 | |
| cream | SDN1700423 | |
| aluminium | SDN1700460 | |
| titanium | SDN1700468 | |
| beige | SDN1700447 | |
| graphite | SDN1700470 | |

Comfort controls

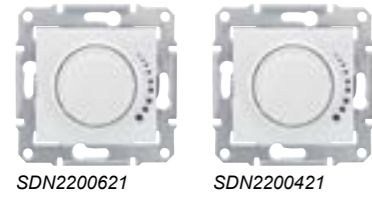

SDN2200621 SDN2200421

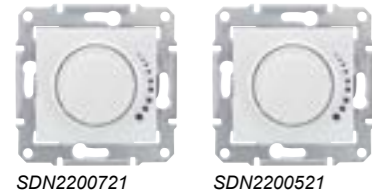

SDN2200721 SDN2200521



SDN2200921



SDN2201221

| Colour | RC, 230 V, 25-325 VA | RL, 230 V, 60-500 VA |
|-----------|----------------------|----------------------|
| white | SDN2200621 | SDN2200421 |
| cream | SDN2200623 | SDN2200423 |
| aluminium | SDN2200660 | SDN2200460 |
| titanium | SDN2200668 | SDN2200468 |
| beige | SDN2200647 | SDN2200447 |
| graphite | SDN2200670 | SDN2200470 |

| Colour | RC, 230 V, 25-325 VA, two-way | RL, 230 V, 60-500 VA, two-way |
|-----------|-------------------------------|-------------------------------|
| white | SDN2200721 | SDN2200521 |
| cream | SDN2200723 | SDN2200523 |
| aluminium | SDN2200760 | SDN2200560 |
| titanium | SDN2200768 | SDN2200568 |
| beige | SDN2200747 | SDN2200547 |
| graphite | SDN2200770 | SDN2200570 |

| Colour | RL, 230 V, 1000 VA |
|-----------|--------------------|
| white | SDN2200921 |
| cream | SDN2200923 |
| aluminium | SDN2200960 |
| titanium | SDN2200968 |
| beige | SDN2200947 |
| graphite | SDN2200970 |

- with an additional switch output which enables an additional load to be switched on and off
- minimum brightness setting.

| Colour | RL-RC, 230 V, 4-400 VA, two-way |
|-----------|---------------------------------|
| white | SDN2201221 |
| cream | SDN2201223 |
| aluminium | SDN2201260 |
| titanium | SDN2201268 |
| beige | SDN2201247 |
| graphite | SDN2201270 |

Load table

| SDN22006XX | SDN22004XX | SDN22009XX | SDN22007XX | SDN22005XX | SDN22012XX | |
|------------|------------|------------|------------|------------|------------|--|
| 25-325 W | 60-500 W | 40-1000 W | 25-325 W | 60-500 W | 4-400 W | incandescent lamps |
| 25-325 W | 60-500 W | 40-1000 W | 25-325 W | 60-500 W | 4-400 W | 230 V AC halogen lamps |
| | 60-500 VA | 60-1000 VA | | 60-500 VA | 4-400 VA | 230 V/12 V AC halogen lamps with ferromagnetic transformer |
| 25-325 VA | | | 25-325 VA | | 4-400 VA | 230 V/12 V AC halogen lamps with electronic transformer |
| | | | | | 4-400 VA | 230 V/12 V AC halogen lamps with toroidal transformer |
| | | 60-600 W | | | | 230 V AC single-phase motors |
| | | | | | 4-200 VA | LED lamps (RC-mode) |
| | | | | | 4-40 VA | LED lamps (RL-LED-mode) |
| | | | | | | Fuse |
| | | | | | | 2.5 A(H) |
| | | | | | | Electronic |

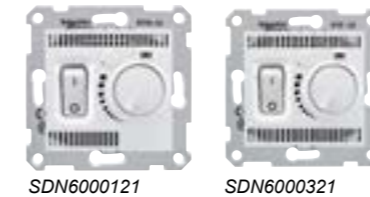

SDN6000121 SDN6000321



SDN6001121



SDN2710221



SDN2720221

Thermostats

| Colour | 10 A - 230 V AC, room thermostat | 10 A - 230 V AC, floor thermostat |
|-----------|----------------------------------|-----------------------------------|
| white | SDN6000121 | SDN6000321 |
| cream | SDN6000123 | SDN6000323 |
| aluminium | SDN6000160 | SDN6000360 |
| titanium | SDN6000168 | SDN6000368 |
| beige | SDN6000147 | SDN6000347 |
| graphite | SDN6000170 | SDN6000370 |

- Delivered with 4.0 m sensor
- External sensor: NTC 10 kΩ at 25 °C

| Colour | 10 A - 230 V AC, room thermostat with cooling mode |
|--------|--|
| white | SDN6001121 |

Complete assembled products. Can not be used in multigang frame installation

USB chargers

| Colour | Double USB chargers, 2.1 A, A + A |
|-----------|-----------------------------------|
| white | SDN2710221 |
| cream | SDN2710223 |
| aluminium | SDN2710260 |
| titanium | SDN2710268 |
| beige | SDN2710247 |
| graphite | SDN2710270 |

| Colour | Double USB chargers, 2.4 A, A + C |
|-----------|-----------------------------------|
| white | SDN2720221 |
| cream | SDN2720223 |
| aluminium | SDN2720260 |
| titanium | SDN2720268 |
| beige | SDN2720247 |
| graphite | SDN2720270 |

- Nominal input voltage: 100-240 V AC ±10 %
- USB output voltage: 5 V DC ± 5 %
- Nominal output current: 1 x 2.1 A or 2 x 1.05 A (for 2 outputs) for SDN27102xx
- Nominal output current: 1 x 2.4 A or 2 x 1.2 A (for 2 outputs) for SDN27202xx
- Power consumption: < 0.1 W (in stand-by)
- Maximum output power: 10.5 W for SDN27102xx
- Maximum output power: 12 W for SDN27202xx
- Expected lifetime: 30 000 h for output power 10.5 W
- Overtoltage category: OVC III
- Isolation class: class II

Sedna

Mechanisms

without cover frame

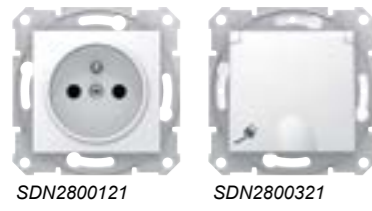
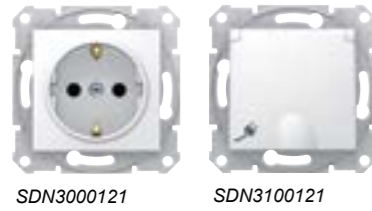

Socket-outlets

Side earth socket-outlets

| Colour | 16 A - 250 V AC, 2P+E, shuttered, lift terminals | 16 A - 250 V AC, 2P+E, shuttered, screwless | 16 A - 250 V AC, 2P+E, shuttered, lift terminals, with lid | 16 A - 250 V AC, 2P+E, shuttered, screwless, with lid |
|-----------|--|---|--|---|
| white | SDN3000121 | SDN3001721 | SDN3100121 | SDN3100421 |
| cream | SDN3000123 | SDN3001723 | SDN3100123 | SDN3100423 |
| aluminium | SDN3000160 | SDN3001760 | SDN3100160 | SDN3100460 |
| titanium | SDN3000168 | SDN3001768 | SDN3100168 | SDN3100468 |
| beige | SDN3000147 | SDN3001747 | SDN3100147 | SDN3100447 |
| graphite | SDN3000170 | SDN3001770 | SDN3100170 | SDN3100470 |
| red | SDN3000341 | | | |
| Colour | 16 A - 250 V AC, 2P+E, lift terminals | 16 A - 250 V AC, 2P+E, screwless | 16 A - 250 V AC, 2P+E, shuttered, lift terminals, with lid | 16 A - 250 V AC, 2P+E, IP44, shuttered, screwless, with lid |
| white | SDN3000521 | SDN3001821 | SDN3100321 | SDN3100521 |
| cream | SDN3000523 | SDN3001823 | SDN3100323 | SDN3100523 |
| aluminium | SDN3000560 | SDN3001860 | SDN3100360 | SDN3100560 |
| titanium | SDN3000568 | SDN3001868 | SDN3100368 | SDN3100568 |
| beige | SDN3000547 | SDN3001847 | SDN3100347 | SDN3100547 |
| graphite | SDN3000570 | SDN3001870 | SDN3100370 | SDN3100570 |

Pin earth socket-outlets

| Colour | 16 A - 250 V AC, 2P+E, shuttered, lift terminals | 16 A - 250 V AC, 2P+E, shuttered screwless | 16 A - 250 V AC, 2P+E, IP44, shuttered, lift terminals, with lid | 16 A - 250 V AC, 2P+E, IP44, shuttered, screwless, with lid |
|-----------|--|--|--|---|
| white | SDN2800121 | SDN2800721 | SDN2800321 | SDN2800821 |
| cream | SDN2800123 | SDN2800723 | SDN2800323 | SDN2800823 |
| aluminium | SDN2800160 | SDN2800760 | SDN2800360 | SDN2800860 |
| titanium | SDN2800168 | SDN2800768 | SDN2800368 | SDN2800868 |
| beige | SDN2800147 | SDN2800747 | SDN2800347 | SDN2800847 |
| graphite | SDN2800170 | SDN2800770 | SDN2800370 | SDN2800870 |
| red | SDN2800441 | | | |

Socket-outlets without earth

| Colour | 16 A - 250 V AC, 2P, lift terminals | 16 A - 250 V AC, 2P, screwless |
|-----------|-------------------------------------|--------------------------------|
| white | SDN2900121 | SDN2900221 |
| cream | SDN2900123 | SDN2900223 |
| aluminium | SDN2900160 | SDN2900260 |
| titanium | SDN2900168 | SDN2900268 |
| beige | SDN2900147 | SDN2900247 |
| graphite | SDN2900170 | SDN2900270 |

Double socket-outlet with pin earth - PL standard - multigang

| Colour | 16 A - 250 V AC, 2P+E, lift terminals |
|-----------|---------------------------------------|
| white | SDN2800921 |
| cream | SDN2800923 |
| aluminium | SDN2800960 |
| titanium | SDN2800968 |
| graphite | SDN2800970 |

Sedna

Mechanisms

without cover frame

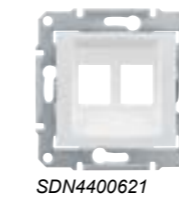
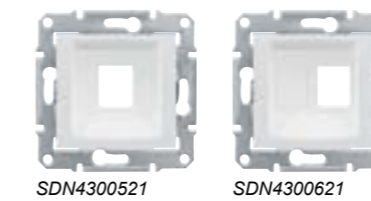
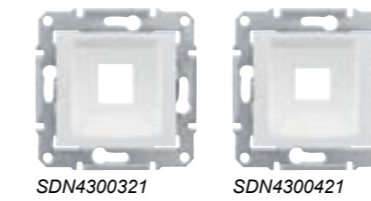
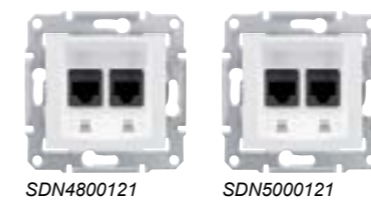
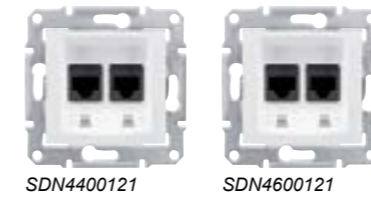
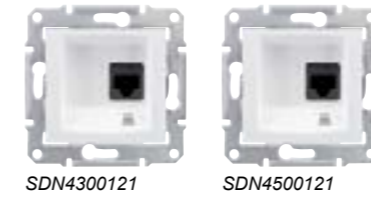

Data outlets

RJ45 category 5e

| Colour | 1 x RJ45, cat. 5e, UTP, IDC* | 1 x RJ45, cat. 5e, STP, IDC* |
|-----------|------------------------------|------------------------------|
| white | SDN4300121 | SDN4500121 |
| cream | SDN4300123 | SDN4500123 |
| aluminium | SDN4300160 | SDN4500160 |
| titanium | SDN4300168 | SDN4500168 |
| beige | SDN4300147 | SDN4500147 |
| graphite | SDN4300170 | SDN4500170 |
| Colour | 2 x RJ45, cat. 5e, UTP, IDC* | 2 x RJ45, cat. 5e, STP, IDC* |
| white | SDN4400121 | SDN4600121 |
| cream | SDN4400123 | SDN4600123 |
| aluminium | SDN4400160 | SDN4600160 |
| titanium | SDN4400168 | SDN4600168 |
| beige | SDN4400147 | SDN4600147 |
| graphite | SDN4400170 | SDN4600170 |

RJ45 category 6

| Colour | 1 x RJ45, cat. 6, UTP, IDC* | 1 x RJ45, cat. 6, STP, IDC* |
|-----------|-----------------------------|-----------------------------|
| white | SDN4700121 | SDN4900121 |
| cream | SDN4700123 | SDN4900123 |
| aluminium | SDN4700160 | SDN4900160 |
| titanium | SDN4700168 | |
| beige | SDN4700147 | SDN4900147 |
| graphite | SDN4700170 | SDN4900170 |
| Colour | 2 x RJ45, cat. 6, UTP, IDC* | 2 x RJ45, cat. 6, STP, IDC* |
| white | SDN4800121 | SDN5000121 |
| cream | SDN4800123 | SDN5000123 |
| aluminium | SDN4800160 | SDN5000160 |
| titanium | SDN4800168 | |
| beige | SDN4800147 | SDN5000147 |
| graphite | SDN4800170 | SDN5000170 |

* IDC: Insulation Displacement Connection in RJ45 connectors.

Plate for 1 x RJ45 without connectors

| Colour | KRONE, cat. 5e, cat. 6, UTP | RDM, cat. 5e, cat. 6, UTP |
|-----------|--------------------------------|--|
| white | SDN4300321 | SDN4300421 |
| cream | SDN4300323 | SDN4300423 |
| aluminium | SDN4300360 | SDN4300460 |
| titanium | | SDN4300468 |
| beige | | |
| graphite | SDN4300370 | SDN4300470 |
| Colour | SYSTEMAX, cat. 5e, cat. 6, UTP | AMP, MOLEX, KELINE, cat. 5e, cat. 6, UTP |
| white | SDN4300521 | SDN4300621 |
| cream | | SDN4300623 |
| aluminium | SDN4300560 | SDN4300660 |
| titanium | | SDN4300668 |
| beige | | SDN4300647 |
| graphite | SDN4300570 | SDN4300670 |

Plate for 2 x RJ45 without connectors

| Colour | AMP, MOLEX, KELINE, cat. 5e, cat. 6, UTP |
|-----------|--|
| white | SDN4400621 |
| cream | SDN4400623 |
| aluminium | SDN4400660 |
| titanium | SDN4400668 |
| beige | SDN4400647 |
| graphite | SDN4400670 |

Telephone outlets

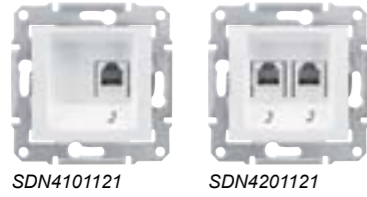

SDN4101121 SDN4201121

RJ11

| Colour | 1 x RJ11, screw terminals | 2 x RJ11, screw terminals |
|-----------|---------------------------|---------------------------|
| white | SDN4101121 | SDN4201121 |
| cream | SDN4101123 | SDN4201123 |
| aluminium | SDN4101160 | SDN4201160 |
| titanium | SDN4101168 | SDN4201168 |
| beige | SDN4101147 | SDN4201147 |
| graphite | SDN4101170 | SDN4201170 |

Telephone + data outlets



SDN5100121



SDN5200121

| Colour | RJ11 + RJ45, cat. 5e, UTP, IDC* + screw terminals | |
|-----------|---|--|
| white | SDN5100121 | |
| cream | SDN5100123 | |
| aluminium | SDN5100160 | |
| titanium | SDN5100168 | |
| beige | SDN5100147 | |
| graphite | SDN5100170 | |
| Colour | RJ11 + RJ45, cat. 6, UTP, IDC* + screw terminals | RJ11 + RJ45, cat. 6, STP, IDC* + screw terminals |
| white | SDN5200121 | |
| cream | SDN5200123 | |
| aluminium | SDN5200160 | |
| titanium | SDN5200168 | |
| beige | SDN5200147 | SDN5200247 |
| graphite | SDN5200170 | |

* IDC: Insulation Displacement Connection in RJ45 connectors.

TV/R/SAT outlets

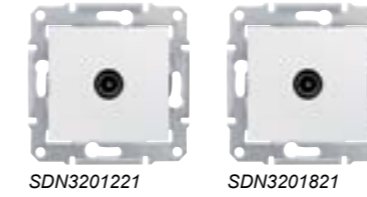

SDN3201221 SDN3201821



SDN3201621

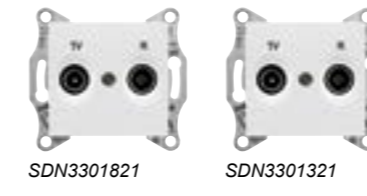

SDN3301821 SDN3301321

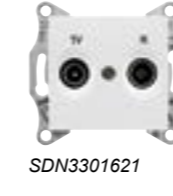

SDN3301621

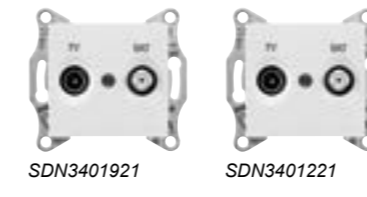

SDN3401921 SDN3401221

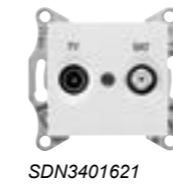

SDN3401621

TV

| Colour | TV connector, intermediate, 4 dB | TV connector, intermediate, 8 dB |
|-----------|----------------------------------|----------------------------------|
| white | SDN3201821 | SDN3201221 |
| cream | SDN3201823 | SDN3201223 |
| aluminium | SDN3201860 | SDN3201260 |
| titanium | SDN3201847 | SDN3201268 |
| beige | SDN3201870 | SDN3201247 |
| graphite | SDN3201870 | SDN3201270 |
| Colour | TV connector ending, 1 dB | |
| white | SDN3201621 | |
| cream | SDN3201623 | |
| aluminium | SDN3201660 | |
| titanium | SDN3201668 | |
| beige | SDN3201647 | |
| graphite | SDN3201670 | |

TV/R

| Colour | TV/R outlet, intermediate, 4 dB | TV/R outlet, intermediate, 8 dB |
|-----------|---------------------------------|---------------------------------|
| white | SDN3301821 | SDN3301321 |
| cream | SDN3301823 | SDN3301323 |
| aluminium | SDN3301860 | SDN3301360 |
| titanium | SDN3301868 | SDN3301368 |
| beige | SDN3301847 | SDN3301347 |
| graphite | SDN3301870 | SDN3301370 |
| Colour | TV/R outlet, ending, 1 dB | |
| white | SDN3301621 | |
| cream | SDN3301623 | |
| aluminium | SDN3301660 | |
| titanium | SDN3301668 | |
| beige | SDN3301647 | |
| graphite | SDN3301670 | |

TV/SAT

| Colour | TV/SAT outlet, intermediate, 4 dB | TV/SAT outlet, intermediate, 8 dB |
|-----------|-----------------------------------|-----------------------------------|
| white | SDN3401921 | SDN3401221 |
| cream | SDN3401923 | SDN3401223 |
| aluminium | SDN3401960 | SDN3401260 |
| titanium | SDN3401968 | SDN3401268 |
| beige | SDN3401947 | SDN3401247 |
| graphite | SDN3401970 | SDN3401270 |
| Colour | TV/SAT outlet, ending, 1 dB | |
| white | SDN3401621 | |
| cream | SDN3401623 | |
| aluminium | SDN3401660 | |
| titanium | SDN3401668 | |
| beige | SDN3401647 | |
| graphite | SDN3401670 | |

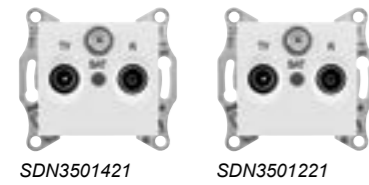

TV/R/SAT outlets (cont'd)

TV/R/SAT

| Colour | TV/R/SAT outlet, intermediate, 4 dB | TV/R/SAT outlet, intermediate, 8 dB |
|-----------|-------------------------------------|-------------------------------------|
| white | SDN3501421 | SDN3501221 |
| cream | SDN3501423 | SDN3501223 |
| aluminium | SDN3501460 | SDN3501260 |
| titanium | SDN3501468 | SDN3501268 |
| beige | SDN3501447 | SDN3501247 |
| graphite | SDN3501470 | SDN3501270 |
| Colour | TV/R/SAT outlet, ending, 1 dB | |
| white | SDN3501321 | |
| cream | SDN3501323 | |
| aluminium | SDN3501360 | |
| titanium | SDN3501368 | |
| beige | SDN3501347 | |
| graphite | SDN3501370 | |

TV/SAT/SAT

| Colour | TV/SAT/SAT outlet, ending, 1 dB |
|-----------|---------------------------------|
| white | SDN3502121 |
| cream | SDN3502123 |
| aluminium | SDN3502160 |
| titanium | SDN3502168 |
| beige | SDN3502147 |
| graphite | SDN3502170 |

| Colour | TV/R center plates | TV/SAT center plates |
|-----------|--------------------|----------------------|
| white | SDN3311321 | SDN3411221 |
| cream | | |
| aluminium | SDN3311360 | SDN3411260 |
| titanium | | |
| beige | | |
| graphite | SDN3311370 | SDN3411270 |

Loudspeaker outlet

| Colour | Double loudspeaker outlet, screwless |
|-----------|--------------------------------------|
| white | SDN5400121 |
| cream | SDN5400123 |
| aluminium | SDN5400160 |
| titanium | SDN5400168 |
| beige | SDN5400147 |
| graphite | SDN5400170 |



Complementary offers

| Colour | Cable outlet 250 V - 25 A |
|-----------|------------------------------|
| white | SDN5500121 |
| cream | SDN5500123 |
| aluminium | SDN5500160 |
| titanium | SDN5500168 |
| beige | SDN5500147 |
| graphite | SDN5500170 |
| Colour | Blind cover |
| white | SDN5600121 |
| cream | SDN5600123 |
| aluminium | SDN5600160 |
| titanium | SDN5600168 |
| beige | SDN5600147 |
| graphite | SDN5600170 |
| Colour | Night light lamp 250 V - 3 W |
| white | SDN5900123 |

LED Modules for switches and push-buttons

| | |
|-------------------------------------|------------|
| Module 1-pole locator lamp | SDN14L0121 |
| Module 2-way, intermediate locator | SDN15L0121 |
| Module 2-circuit locator | SDN03L0121 |
| Module indicator lamp | SDN04L0121 |
| Module 12V push-button locator lamp | SDN17L0121 |
| Module card switch locator | SDN19L0121 |

Spare parts - White rockers for switches and push-buttons

| | |
|--|------------|
| Single rocker | SDN01R0121 |
| Double rocker | SDN03R0121 |
| Single rocker with locator/indicator | SDN14R0121 |
| Double rocker with locator/indicator | SDN03R1121 |
| Double rocker for roller blinds and shutters control | SDN13R0121 |



SDN0400821



SDN3000821



SDN3000421



SDN2800521



SDN2800621

Switches

1 pole 2 way switch

| Colour | 10 AX with frame white |
|--------------------------------|------------------------|
| <input type="checkbox"/> white | SDN0400821 |

Socket-outlets

Single socket-outlet, side earth

| Colour | 16 A shutters, with frame white |
|--------------------------------|---------------------------------|
| <input type="checkbox"/> white | SDN3000821 |

Double socket-outlet with side earth

| Colour | 16 A - 250 V AC, 2P+E, shuttered with lift terminals |
|------------------------------------|--|
| <input type="checkbox"/> white | SDN3000421 |
| <input type="checkbox"/> cream | SDN3000423 |
| <input type="checkbox"/> aluminium | SDN3000460 |
| <input type="checkbox"/> titanium | SDN3000468 |
| <input type="checkbox"/> beige | SDN3000447 |
| <input type="checkbox"/> graphite | SDN3000470 |

Double socket-outlet with pin earth - CZ, SK standard

| Colour | 16 A - 250 V AC, 2P+E, shuttered with lift terminals |
|------------------------------------|--|
| <input type="checkbox"/> white | SDN2800521 |
| <input type="checkbox"/> cream | SDN2800523 |
| <input type="checkbox"/> aluminium | SDN2800560 |
| <input type="checkbox"/> titanium | SDN2800568 |
| <input type="checkbox"/> beige | SDN2800547 |
| <input type="checkbox"/> graphite | SDN2800570 |

Double socket-outlet with pin earth - PL standard

| Colour | 16 A - 250 V AC, 2P+E, shuttered with lift terminals |
|------------------------------------|--|
| <input type="checkbox"/> white | SDN2800621 |
| <input type="checkbox"/> cream | SDN2800623 |
| <input type="checkbox"/> aluminium | SDN2800660 |
| <input type="checkbox"/> titanium | SDN2800668 |
| <input type="checkbox"/> graphite | SDN2800670 |

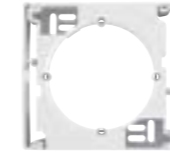

SDN6100121

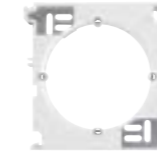

SDN6100221

Horizontal surface mounting boxes

| Colour | 1 gang | Multi-gang, universal |
|------------------------------------|------------|---|
| <input type="checkbox"/> white | SDN6100121 | SDN6100221 |
| <input type="checkbox"/> cream | SDN6100123 | SDN6100223 |
| <input type="checkbox"/> aluminium | SDN6100160 | SDN6100260 |
| <input type="checkbox"/> titanium | SDN6100168 | SDN6100268 |
| <input type="checkbox"/> beige | SDN6100147 | SDN6100247 |
| <input type="checkbox"/> graphite | SDN6100170 | SDN6100270 |
| | | 2-gang box: SDN61001xx + SDN61002xx |
| | | 3-gang box: SDN61001xx + 2 x SDN61002xx |



| Colour | 1 gang | 1 gang- IP 44 |
|-------------------------|-------------------------|---------------|
| white | SDN5800121 | SDN5810521 |
| cream | SDN5800123 | SDN5810523 |
| aluminium | SDN5800160 | SDN5810560 |
| titanium | SDN5800168 | SDN5810568 |
| beige | SDN5800147 | SDN5810547 |
| graphite | SDN5800170 | SDN5810570 |
| grey | SDN5800133 | |
| red | SDN5800141 | |
| 2 gang horizontal frame | 2 gang horizontal- IP44 | |
| white | SDN5800321 | SDN5810621 |
| cream | SDN5800323 | SDN5810623 |
| aluminium | SDN5800360 | SDN5810660 |
| titanium | SDN5800368 | SDN5810668 |
| beige | SDN5800347 | SDN5810647 |
| graphite | SDN5800370 | SDN5810670 |
| grey | SDN5800333 | |
| red | SDN5800341 | |
| 2 gang vertical frame | | |
| white | SDN5801121 | |
| cream | SDN5801123 | |
| aluminium | SDN5801160 | |
| titanium | SDN5801168 | |
| beige | SDN5801147 | |
| graphite | SDN5801170 | |
| grey | SDN5801133 | |
| red | SDN5801141 | |
| 3 gang horizontal frame | 3 gang horizontal- IP44 | |
| white | SDN5800521 | SDN5810721 |
| cream | SDN5800523 | SDN5810723 |
| aluminium | SDN5800560 | SDN5810760 |
| titanium | SDN5800568 | SDN5810768 |
| beige | SDN5800547 | SDN5810747 |
| graphite | SDN5800570 | SDN5810770 |
| grey | SDN5800533 | |
| red | SDN5800541 | |
| 3 gang vertical frame | | |
| white | SDN5801321 | |
| cream | SDN5801323 | |
| aluminium | SDN5801360 | |
| titanium | SDN5801368 | |
| beige | SDN5801347 | |
| graphite | SDN5801370 | |
| grey | SDN5801333 | |
| red | SDN5801341 | |
| 4 gang horizontal frame | | |
| white | SDN5800721 | |
| cream | SDN5800723 | |
| aluminium | SDN5800760 | |
| titanium | SDN5800768 | |
| beige | SDN5800747 | |
| graphite | SDN5800770 | |
| grey | SDN5800733 | |
| red | SDN5800741 | |
| 4 gang vertical frame | | |
| white | SDN5802021 | |
| cream | SDN5802023 | |
| aluminium | SDN5802060 | |
| titanium | SDN5802068 | |
| beige | SDN5802047 | |
| graphite | SDN5802070 | |
| grey | SDN5802033 | |
| red | SDN5802041 | |



| Colour | 5 gang horizontal frame |
|-----------------------|-------------------------|
| white | SDN5800921 |
| cream | SDN5800923 |
| aluminium | SDN5800960 |
| titanium | SDN5800968 |
| beige | SDN5800947 |
| graphite | SDN5800970 |
| grey | SDN5800933 |
| red | SDN5800941 |
| 5 gang vertical frame | |
| white | SDN5801521 |
| cream | SDN5801523 |
| aluminium | SDN5801560 |
| titanium | SDN5801568 |
| beige | SDN5801547 |
| graphite | SDN5801570 |
| grey | SDN5801533 |
| red | SDN5801541 |

Switches and push-buttons connection examples

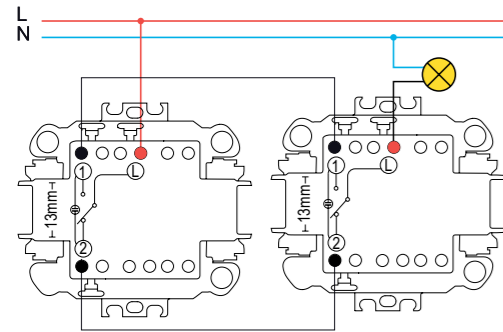

2 two-way switches or 2 two-way switches with locator lamp

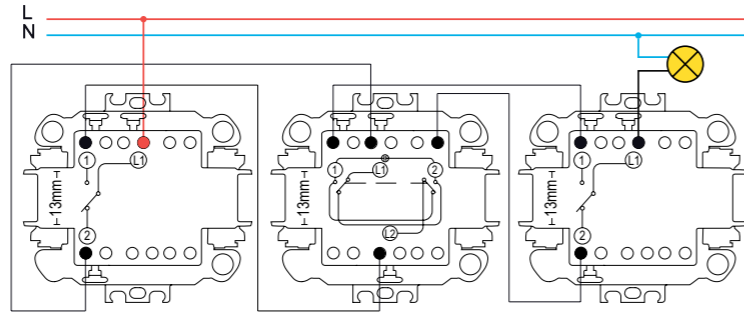

2 two-way switches or 2 two-way switches with locator lamp + 1 intermediate switch

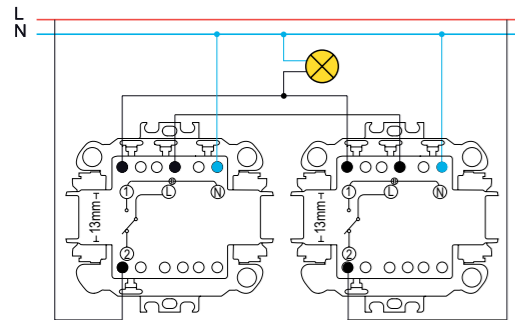

2 two-way switches with indicator lamp

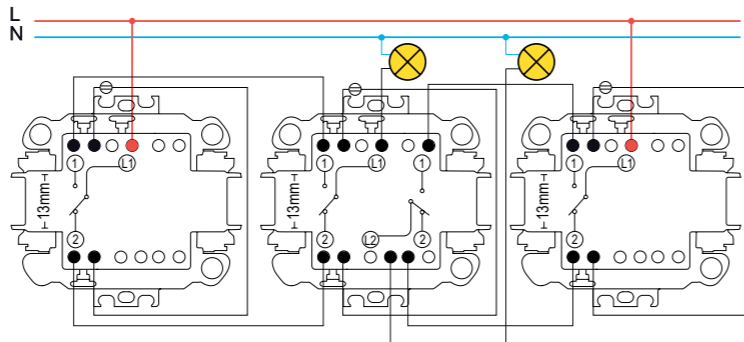

2 two-way switches + 1 double two-way switches

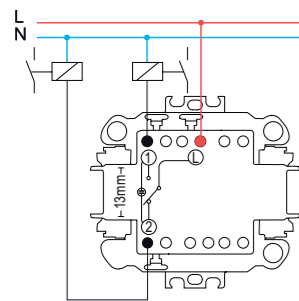

Two-way push-button or two-way push-button with locator lamp

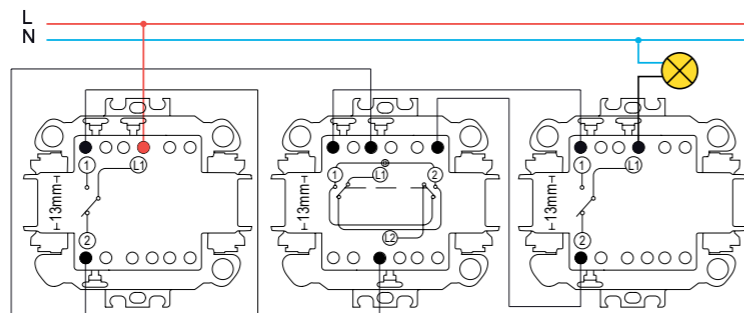

2 two-way switches + 1 intermediate switch with locator lamp

Dimensions (mm)

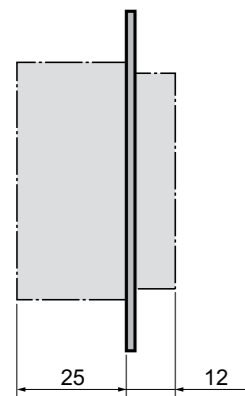

Rotary dimmers RC, 25-325 VA - SDN22006XX

Area of application

- Regulation of different loads (see load table) for homes and buildings.
- Suitable for renovation as it allows replacement of a switch by a regulator without having to change cables.
- As the regulator reduces the current supplying the load, it allows considerable energy savings.

Technical data

- Rated voltage: 230 V AC \pm 10 %, 50 Hz,
- Connectable as switch,
- IP degree of protection: IP20,
- Conformity mark: CE,
- Standard: EN 60669-2-1.

Load table

| | 1 | 2 | 3 | 4 |
|------------------------|-------|-------|----|--------|
| 25°C 230 V 50 Hz | | | | |
| Max. | 325 W | 325 W | NO | 325 VA |
| Min. | 25 W | 25 W | | 25 VA |

- 1 - Incandescent lamps
- 2 - Halogen lamps
- 3 - Low voltage halogen lamps with ferromagnetic transformer
- 4 - Low voltage halogen lamps with electronic transformers

Connections

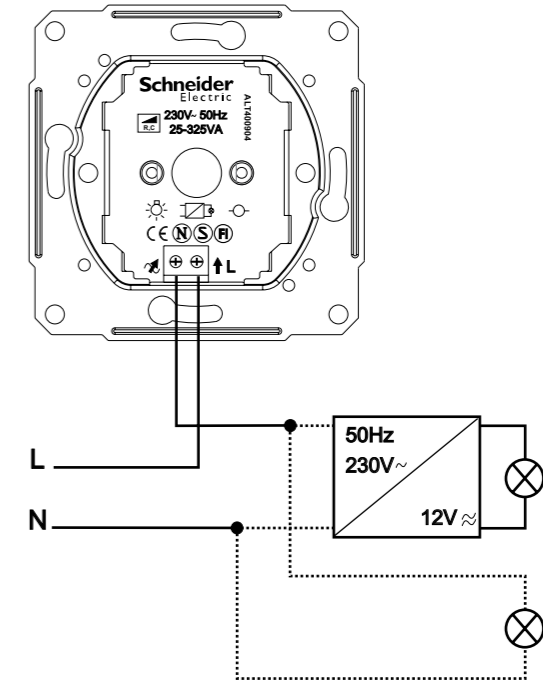

Dimensions (mm)

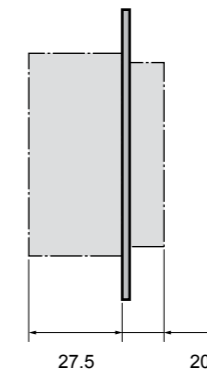

Rotary dimmers RL, 60-500 VA - SDN22004XX

Area of application

- Regulation of different loads (see load table) for homes and buildings.
- Suitable for renovation as it allows replacement of a switch by a regulator without having to change cables.
- As the regulator reduces the current supplying the load, it allows considerable energy savings.

Technical data

- Rated voltage: 230 V AC \pm 10 %, 50 Hz,
- Connectable as switch,
- IP degree of protection: IP20,
- Conformity mark: CE,
- Standard: EN 60669-2-1.

Load table

| | 1 | 2 | 3 | 4 |
|------------------------|-------|-------|--------|----|
| 25°C 230 V 50 Hz | | | | |
| Max. | 500 W | 500 W | 500 VA | NO |
| Min. | 60 W | 60 W | 60 VA | |

- 1 - Incandescent lamps
- 2 - Halogen lamps
- 3 - Low voltage halogen lamps with ferromagnetic transformer
- 4 - Low voltage halogen lamps with electronic transformers

Connections

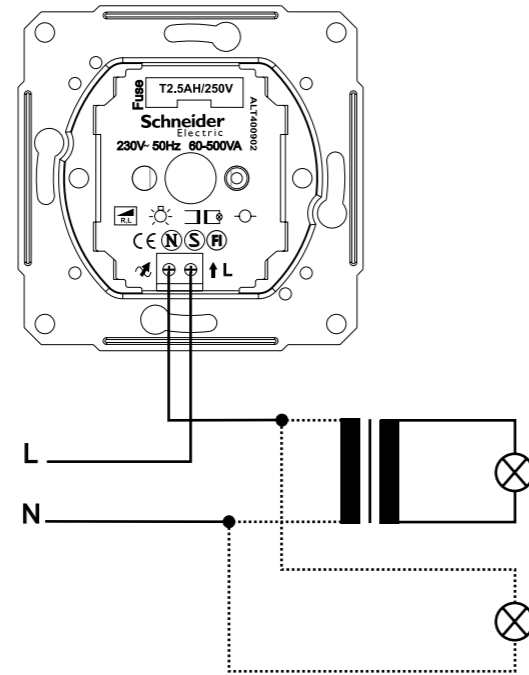

Dimensions (mm)

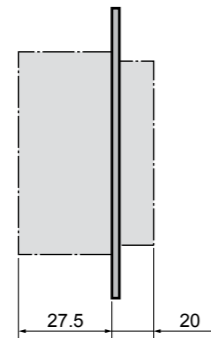

Rotary push-button dimmers RL, 230 V, 1000 VA - SDN22009XX

Area of application

- Regulation of different loads (see load table) for homes and buildings.
- As the regulator reduces the current supplying the load, it allows considerable energy savings.
- A comfort feature: setting minimum brightness level.
- Additional ON/OFF supply possibility to additional load with separated terminal output.

Technical data

- Rated voltage: 230 V AC \pm 10 %, 50 Hz
- Load on the switch output: max. 2 A, $\cos \phi$ 0.6,
- IP degree of protection: IP20,
- Conformity mark: CE,
- Standard: EN 60669-2-1.

Load table

| | 1 | 2 | 3 | 4 | 5 |
|------------------------|--------|--------|---------|----|--------|
| 25°C 230 V 50 Hz | | | | | |
| Max. | 1000 W | 1000 W | 1000 VA | NO | 600 VA |
| Min. | 40 W | 40 W | 60 VA | | 60 VA |

- 1 - Incandescent lamps
- 2 - Halogen lamps
- 3 - Low voltage halogen lamps with ferromagnetic transformer
- 4 - Low voltage halogen lamps with electronic transformers
- 5 - Single-phase motors

Installation

The maximum allowed load is reduced due to the decreased heat dissipation when you do not install the device into a single standard flushmounting box:

| Load reduction by | Mounted in cavity walls* | Several installed together in combination* | In 1-gang or 2-gang surface-mounted housing | In 3-gang surface-mounted housing |
|-------------------|--------------------------|--|---|-----------------------------------|
| 25 % | ■ | ■ | | |
| 30 % | | | ■ | |
| 50 % | | | | ■ |

* If several factors apply, add the load reductions together.

Installing the dimmer and covers

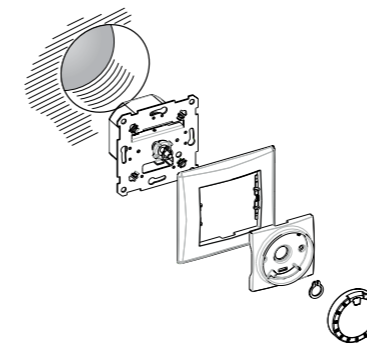

Use

Setting the minimum brightness of the lamps

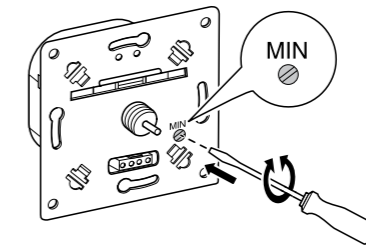

- 1 Set the dimmer.
- 2 Dim the brightness right down using the rotary knob.
- 3 Set the minimum brightness using the set-screw (MIN).

Operating the dimmer

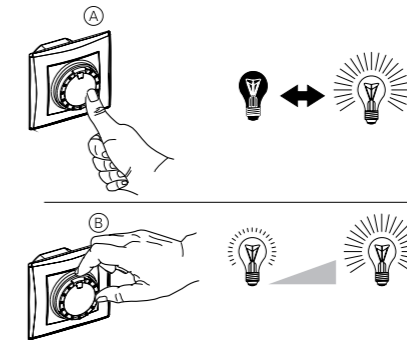

You switch the connected lamps on and off by simply pressing the rotary knob (A). By turning the rotary knob (B), you dim the lamps brighter or darker.

Connections

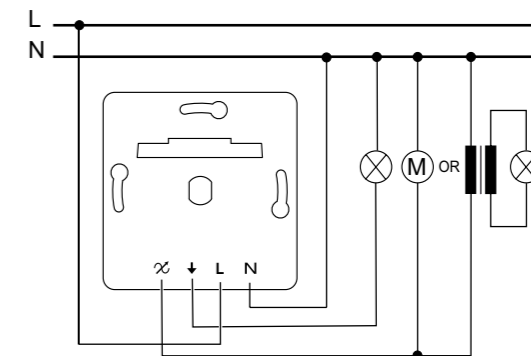

∞ : controlled/dimmed output
↓ : ON/OFF output

Dimensions (mm)

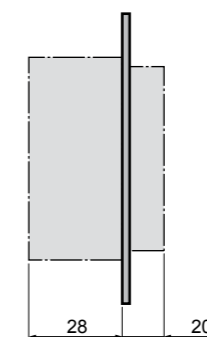

Rotary push-button dimmers RC, 25-325 VA, two-way - SDN22007XX

Area of application

- Regulation of different loads (see load table) for homes and buildings.
- Suitable for renovation as it allows replacement of a switch or a 2-way switch by a regulator without having to change cables.
- As the regulator reduces the current supplying the load, it allows considerable energy savings.

Technical data

- Rated voltage: 230 V AC \pm 10 %, 50 Hz,
- Possibility of connection with a two-way switch or just replace one-way switch,
- IP degree of protection: IP20,
- Conformity mark: CE,
- Standard: EN 60669-2-1.

Load table

| | 1 | 2 | 3 | 4 |
|------------------------|-------|-------|----|--------|
| 25°C 230 V 50 Hz | | | | |
| Max. | 325 W | 325 W | NO | 325 VA |
| Min. | 25 W | 25 W | | 25 VA |

- 1 - Incandescent lamps
- 2 - Halogen lamps
- 3 - Low voltage halogen lamps with ferromagnetic transformer
- 4 - Low voltage halogen lamps with electronic transformers

Connections

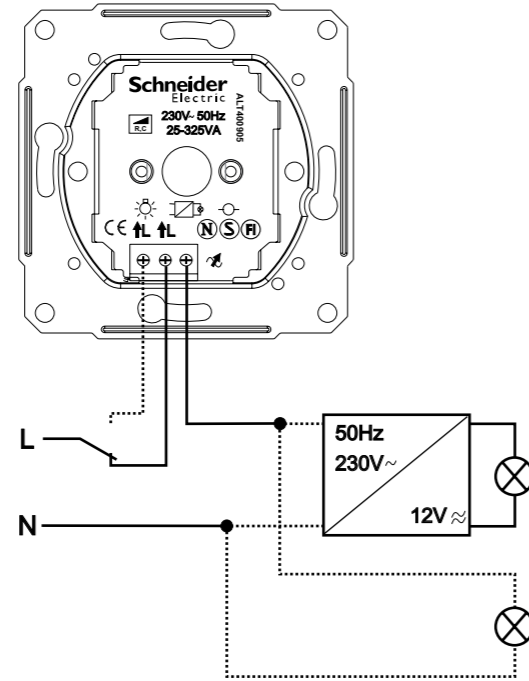

Dimensions (mm)

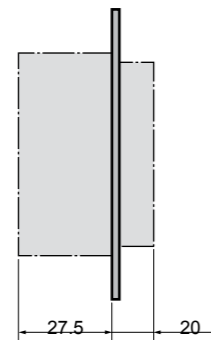

Rotary push-button dimmers RL, 60-500 VA, two-way - SDN22005XX

Area of application

- Regulation of different loads (see load table) for homes and buildings.
- Suitable for renovation as it allows replacement of a switch or a 2-way switch by a regulator without having to change cables.
- As the regulator reduces the current supplying the load, it allows considerable energy savings.

Technical data

- Rated voltage: 230 V AC \pm 10 %, 50 Hz,
- Possibility of connection with a two-way switch or just replace one-way switch,
- Fuse: 2,5 A(H)-230 V AC,
- IP degree of protection: IP20,
- Conformity mark: CE,
- Standard: EN 60669-2-1.

Load table

| | 1 | 2 | 3 | 4 |
|------------------------|-------|-------|--------|----|
| 25°C 230 V 50 Hz | | | | |
| Max. | 500 W | 500 W | 500 VA | NO |
| Min. | 60 W | 60 W | 60 VA | |

- 1 - Incandescent lamps
- 2 - Halogen lamps
- 3 - Low voltage halogen lamps with ferromagnetic transformer
- 4 - Low voltage halogen lamps with electronic transformers

Connections

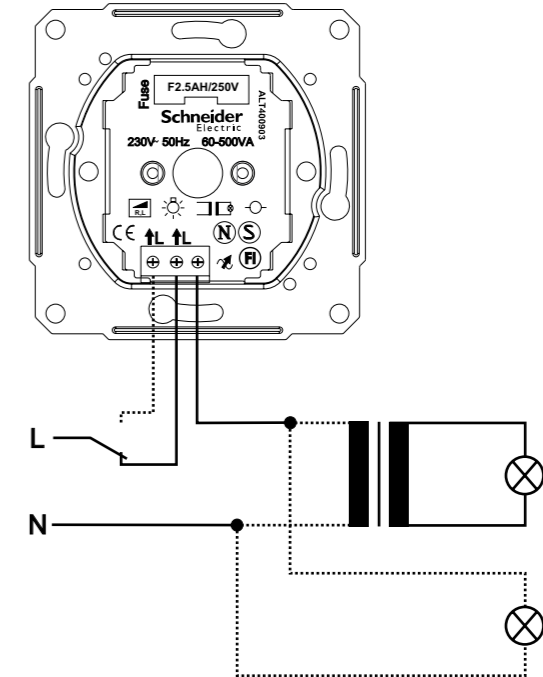

Dimensions (mm)

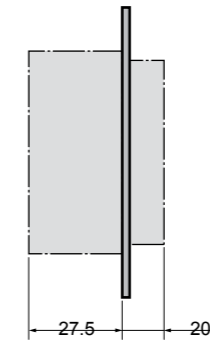

Rotary push-button dimmers RL-RC, 230 V, 4-400 VA, two-way - SDN22012XX

Area of application

- Regulation of different loads (see load table) for homes and buildings.
- Suitable for renovation as it allows replacement of a switch or a 2-way switch by a regulator without having to change cables.
- As the regulator reduces the current supplying the load, it allows considerable energy savings.

Technical data

- Rated voltage: 230 V AC \pm 10 %, 50 Hz,
- Possibility of connection with a two-way switch or just replace one-way switch,
- Switch type: 6 / 1,
- IP degree of protection: IP20,
- Conformity mark: CE,
- Standard: EN 60669-2-1,
- Product certification: FIMKO, NEMKO, SEMKO, VDE.

Load table

| | 1 | 2 | 3 | 4 | 5 | 6 |
|------------------------|-------|-------|--------|--------|--------|--------|
| 25°C 230 V 50 Hz | | | | | | |
| Max. | 400 W | 400 W | 400 VA | 400 VA | 400 VA | 200 VA |
| Min. | 4 W | 4 W | 4 VA | 4 VA | 4 VA | 40 VA |

- 1 - Incandescent lamps
- 2 - Halogen lamps
- 3 - Low voltage halogen lamps with ferromagnetic transformer
- 4 - Low voltage halogen lamps with electronic transformers
- 5 - Low voltage halogen lamps with toroidal transformers
- 6 - Led lamps

Use

- Dimmer is installed into applicable flush or surface mounted installation box, connections according to the wiring diagram.
- Connected load type (resistive, capacitive and inductive) is detected and regulation algorithm is set automatically by the dimmer. The minimum and maximum light level setting is adjustable. Note: Device is not able to regulate capacitive and inductive loads simultaneously!
- The dimmer is designed using 2-wire topology so it can be used to replace a normal switch.
- Alternative connectors for phase-in (two-way switch used to control light from 2 points) are marked L, and regulated phase out has ∞ -symbol. Xmarked connector is not connected internally to the dimmer and it can be used as extension joint. All connectors are applicable for 2 x 2,5mm² wires.

User interface

Lights are switched ON / OFF by pushing the knob and light level is regulated by turning the knob. The dimmer uses soft start function when lights are switched ON.

Protections

The dimmer has electronic protection against the short circuit, over voltage, overload and overheat. If electronic protection has activated, to reset the dimmer for normal operation, push the knob. The dimmer also contains single shot thermal fuse.

Connections

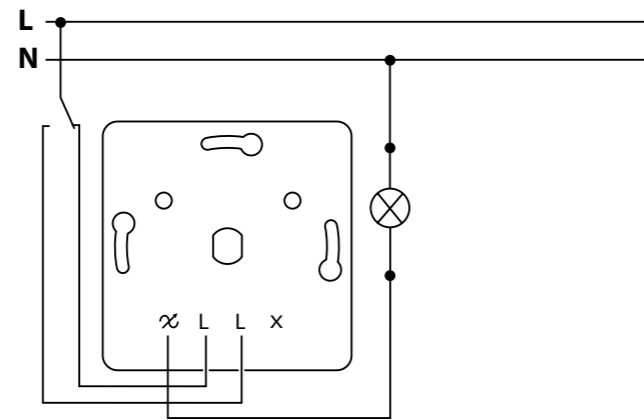

Dimensions (mm)

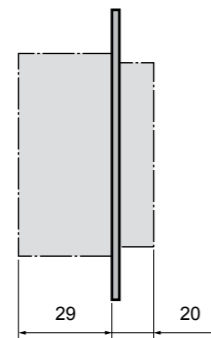

Thermostat 10 A, room thermostat - SDN60001XX

Area of application

Electronic room thermostat is designed for controlling electric heaters like radiators and ceiling heaters. Room thermostat is easy to use and install. It includes ON/OFF switch in front panel and trimmer for temperature set point selection. It has one led to indicate when load is connected. Thermostat full fills EN-60730-2-9 standard and it is RoHS and REACH compliant.

Technical data

- Voltage range: 230 V ac \pm 10 %, 50 Hz,
- Max fuse: 16 A,
- Maximum load: 2300 W (10 A, 230 V, $\cos \phi = 1$),
- Operation temperature: + 5 °C to + 30 °C,
- Temperature control range: + 5 °C to + 30 °C,
- Storage temperature: - 20 °C to + 60 °C
- Control accuracy: 1 °C,
- 2-pole switch in front panel,
- Relay: NO (normally open),
- Led: red,
- Wires/terminal: max 2 x 2,5 mm²
- Terminals have wire protectors (for multicore cables),
- IP degree of protection: IP20,
- Conformity mark: CE,
- Standard: EN 60669-2-1.

Use

- Put thermostat ON/OFF from the switch in front panel.
- Red light indicates that heating is active.
- Adjusting scale indicates suggestive temperature and suitable temperature should be measured by experience.

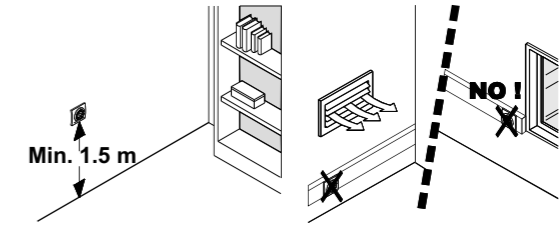

Connections

Put thermostat to a mounting box so that connectors are up. If connection has protective earth (PE) wires use external connectors to connect them together. Thermostat doesn't have terminals for PE.

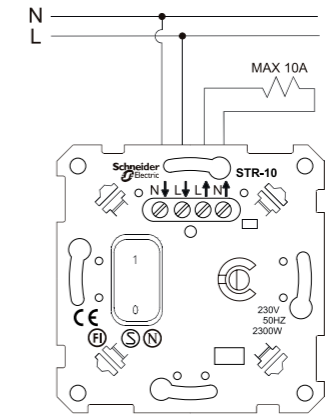

Dimensions (mm)

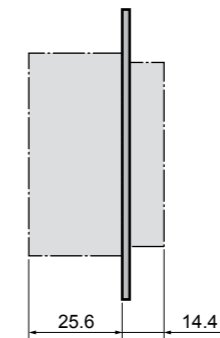

Thermostat 10 A, floor thermostat - SDN60003XX

Area of application

Electronic floor thermostat is designed for floor heating cables and other floor heating applications. Floor thermostat is easy to use and install. It includes ON/OFF switch in front panel and trimmer for temperature set point selection. It has one led to indicate when load is connected. Thermostat full fills EN-60730-2-9 standard and it is RoHS and REACH compliant.

Technical data

- Voltage range: 230 V ac \pm 10 %, 50 Hz,
- Max fuse: 16 A,
- Maximum load: 2300 W (10 A, 230 V, $\cos \varphi = 1$),
- Wires/terminal: max 2 x 2,5 mm²,
- Operation temperature: + 5 °C to + 50 °C,
- Storage temperature: - 20 °C to + 50 °C,
- Temperature control range: + 5 °C to + 50 °C,
- Control accuracy: 1 °C,
- 2-pole switch in front panel,
- Relay: NO (normally open),
- Led: red,
- Terminals have wire protectors (for multicore cables),
- External sensor (attached) 4,0 m double isolated, NTC 10 k Ω at 25 °C,
- IP degree of protection: IP20,
- Conformity mark: CE,
- Standard: EN 60730-2-9.

Use

- Put thermostat ON/OFF from the switch in front panel.
- Red light indicates that heating is active. Warming of the floor takes several hours.
- Adjusting scale indicates suggestive temperature and suitable temperature should be measured by experience.

Connections

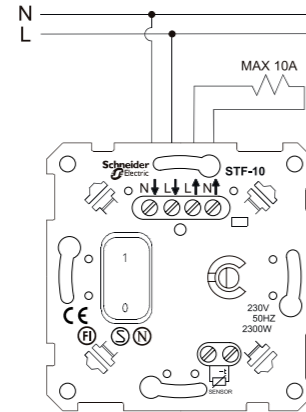

Put thermostat to a mounting box so that connectors are up. If connection has protective earth (PE) wires use external connectors to connect them together. Thermostat doesn't have terminals for PE.

Dimensions (mm)

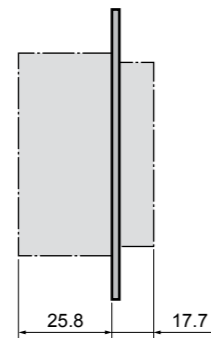

Thermostat 10 A, room thermostat with cooling mode - SDN60011XX

Area of application

Bimetal thermostat with cooling mode can be used to control both heating or cooling systems in dry and closed spaces, such as flats, schools, halls, workshops, etc.

Technical data

- Nominal voltage: 230 V AC
- Temperature adjustment range: 5-30°C
- Nominal current
 - Heating: 10 A resistive and 4 A inductive loads,
 - Cooling: 5 A resistive load and 2 A inductive loads,
- Switching capacity:
 - Heating: 2.2 kW
 - Cooling: 1.1 kW
- Differential gap: approx. 0.5 K
- Maximum humidity: 95 %, no condensation,
- IP degree of protection: IP20,
- Conformity mark: CE,
- Standard: EN 60730-2-9.

Standards

The inserts is interference-suppressed in accordance with EN 55014 and operates according to operating principles 1C.

Connections

Circuit diagram

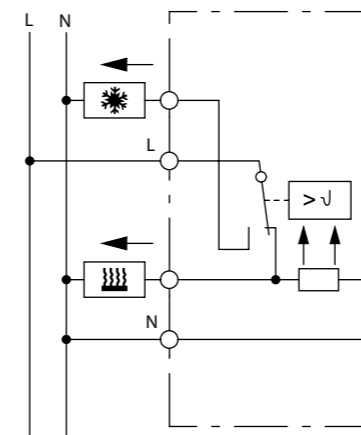

Heating

Cooling

Use

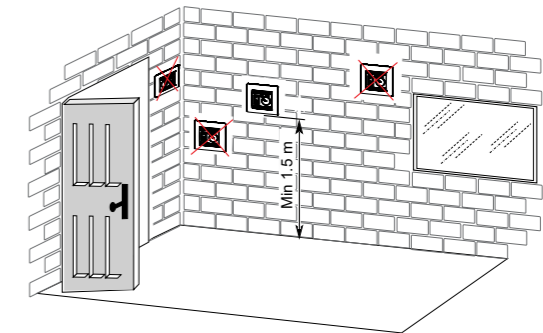

- Installation on interior walls opposite the heat source is preferable
- Mounting height: approx. 1.5 m above the floor
- External walls and draughts from windows and doors should be avoided
- Ensure that the warm air in the room has free access to the controller. Therefore, the controller should not be installed inside shelving units or behind curtains and similar coverings
- External heat affects the accuracy of the control unit adversely. Therefore, avoid direct sunlight, proximity to televisions, radio and heating appliances, lamps, chimneys and heating pipes
- A dimmer also generate heat. If a controller is installed with a dimmer in a shared switch frame, the two should be as far as possible. If they are arranged one on the top of the other, the controller must be below the dimmer.

Commissioning the room temperature control unit

When commissioning the room temperature control unit be aware that the bimetallic element needs time to adjust to the room temperature. Therefore the switching point will deviate from the room temperature directly after installation or after night economy is switched off. The switching points becomes accurate after approx. 1 or 2 hours of operating time. We therefore recommend an initial set temperature that is higher than actually so that initial heating and initial temperature equalisation are faster. After the desired temperature has been reached the temperature setting can be set to the setpoint value required. Use the setting knob to set the temperature required. The scale corresponds to a temperature range of approx. 5 - 30°C.

Dimensions (mm)

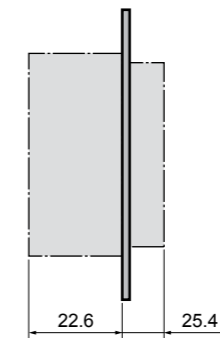

USB chargers

Area of application

USB chargers allow you to quickly charge the battery of a portable device without a mobile charger

Double USB chargers, type A+A, 2.1 A SDN27102XX

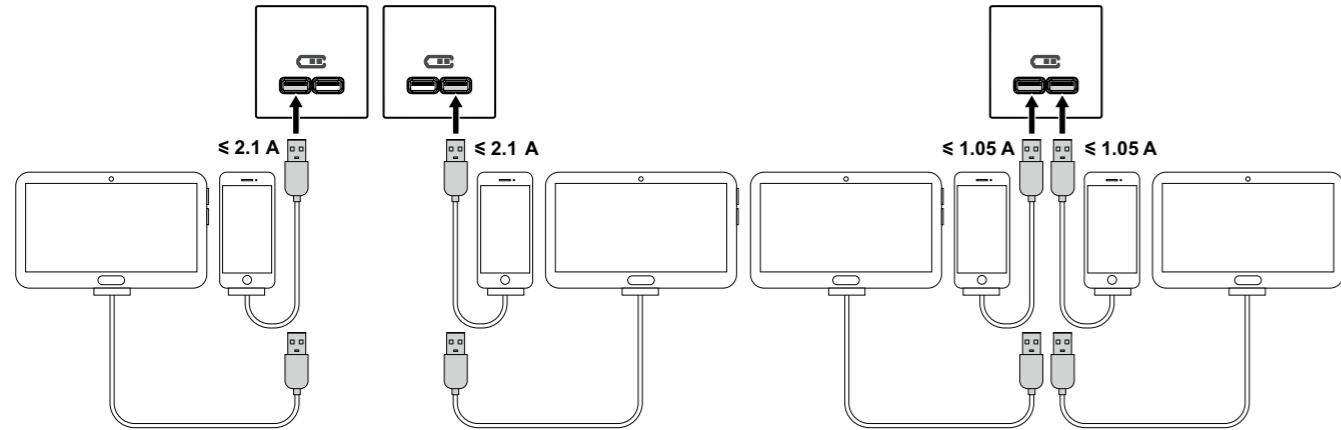

Double USB chargers, type A+C, 2.4 A SDN27202XX

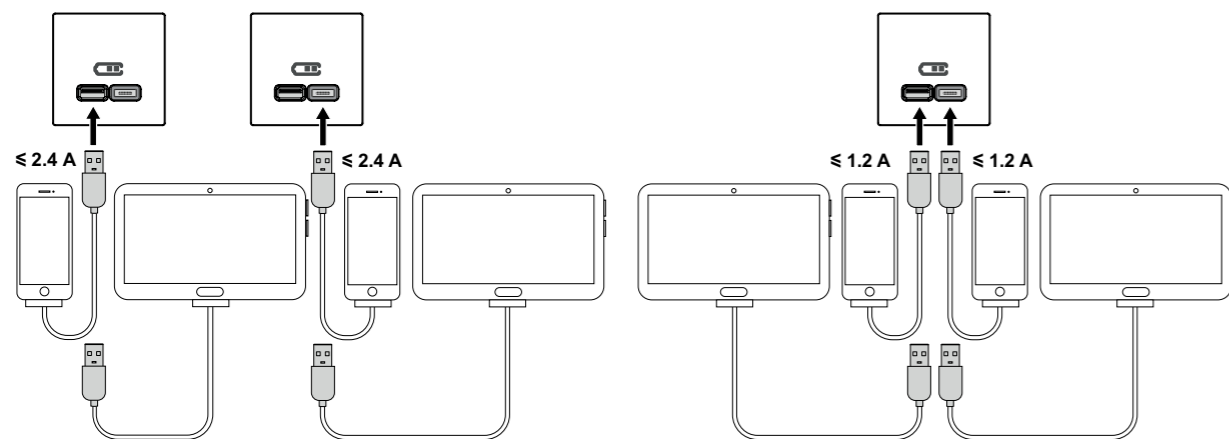

Connection

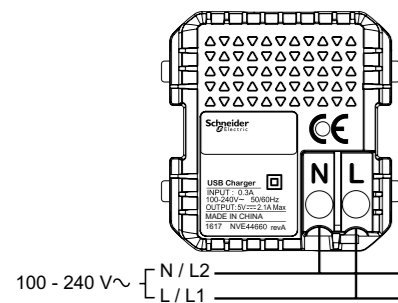

Embedding depth

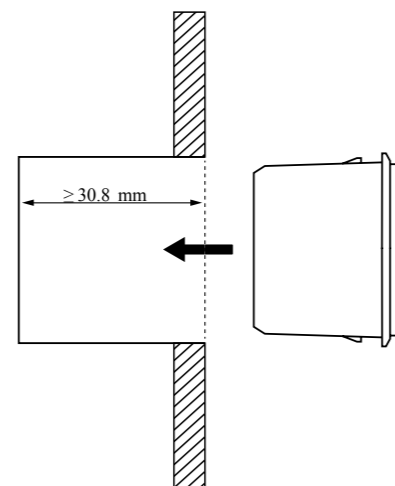

Key card switch SDN19001XX

Area of application

- Particularly recommended for hotel rooms.
- Controls lighting circuits, electrical appliances, electronic equipment, etc.

Technical data

- IP degree of protection: IP20,
- Conformity mark: CE,
- Standard: EN 60669-1,
- Product certifications: S, N, FI.

Connections

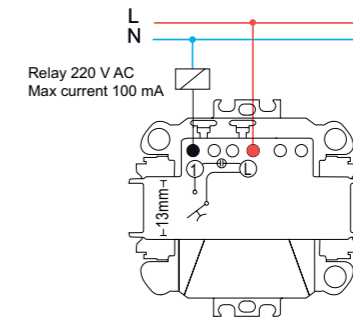

Dimensions (mm)

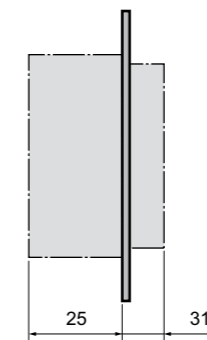

RJ45 data sockets

Area of application

- Given the rapid evolution of the world of computing and telecommunications, today installation of networks is essential in offices and shops (and soon in homes) in order to share information and equipment (printers, scanners, etc.) between several computers.
- These networks consist of cables, connectors, centralising systems and other accessories that, installed in standard, flexible and upgradeable manner (for all Voice, Data, Image transmission applications), make up what is known as structured cabling system.
- The main component of structured cabling is the cable. There are different types of cable for data networks (coaxial, optical fibre, etc.), but the cable most commonly used is the twisted pair cable consisting of 2 insulated and interlaced copper wires.
- There are several types of twisted pair cables:
 - the U/UTP cable (Unshielded Twisted Pair) is a 4-pair twisted cable that is not shielded. It is intended for small and medium installations without electromagnetic pollution
 - the F/UTP cable (Foiled Twisted Pair) is a 4-pair twisted cable with general shielding for external protection, common to all 4 pairs, protecting them against reduced electromagnetic pollution. It is suitable for installations requiring minimum electromagnetic protection
 - the S/FTP cable (Shielded Twisted Pair) is also another 4-pair shielded twisted cable with protective shielding of each pair against high electromagnetic pollution. This minimises emissions. It is suitable for installations requiring a high level of electromagnetic protection.
- The RJ45 socket is an 8-pin connector standardised by ISO8877 for connection of devices to VDI networks.
- One of the standards most commonly used for production of structured cabling is that of the North American Association of electronic and telecommunications manufacturers (EIA/TIA 568B) that has defined a colour code with 2 alternatives, to describe connection of the RJ45 connector.

Technical data

Categories

- The most important property defining a data network is the speed at which information can circulate inside this network.
- According to this aspect, installations are classed into the following categories:

| Category | Transmission rate | Network type |
|---------------------|-------------------|---------------------------------------|
| Cat. 3 | Up to 10 MHz | Ethernet 10 Base T, Token Ring 4 Mbps |
| Cat. 4 | Up to 16 MHz | Token Ring 16 Mbps |
| Cat. 5e | Up to 100 MHz | Ethernet 1000 Base T, ATM 155 Mbps |
| Cat. 6 | Up to 250 MHz | Ethernet 1000 Base T, ATM 1200 |
| Cat. 6 _A | Up to 500 MHz | Ethernet full-duplex mode 1000 Base T |

- So that an installation can be included in a certain category, all the elements making it up must belong to the same category, or, otherwise, it will be classed in the category of the lower category element.

Sedna offer

- The Sedna offer consists of supports for RJ45 connectors and of a broad and comprehensive range.
- This offer satisfies the technical requirements of prevailing regulations soon to be standardised and stand out by the following characteristics:
 - ease of mounting: each connector is equipped with a code of colours and numbers to guide connection at all times without needing special tools
 - high connector quality with category 6 and 6 sockets thus allowing us to propose the quickest connector on the market
 - minimum conductor untwisting for connection, thus preventing electromagnetic interference
 - connection reliability
 - compact size (particularly for the shielded version).

RJ45 data sockets (cont'd)

Installation

Example of unshielded data socket installation (cat 6_A, 5, 5e)

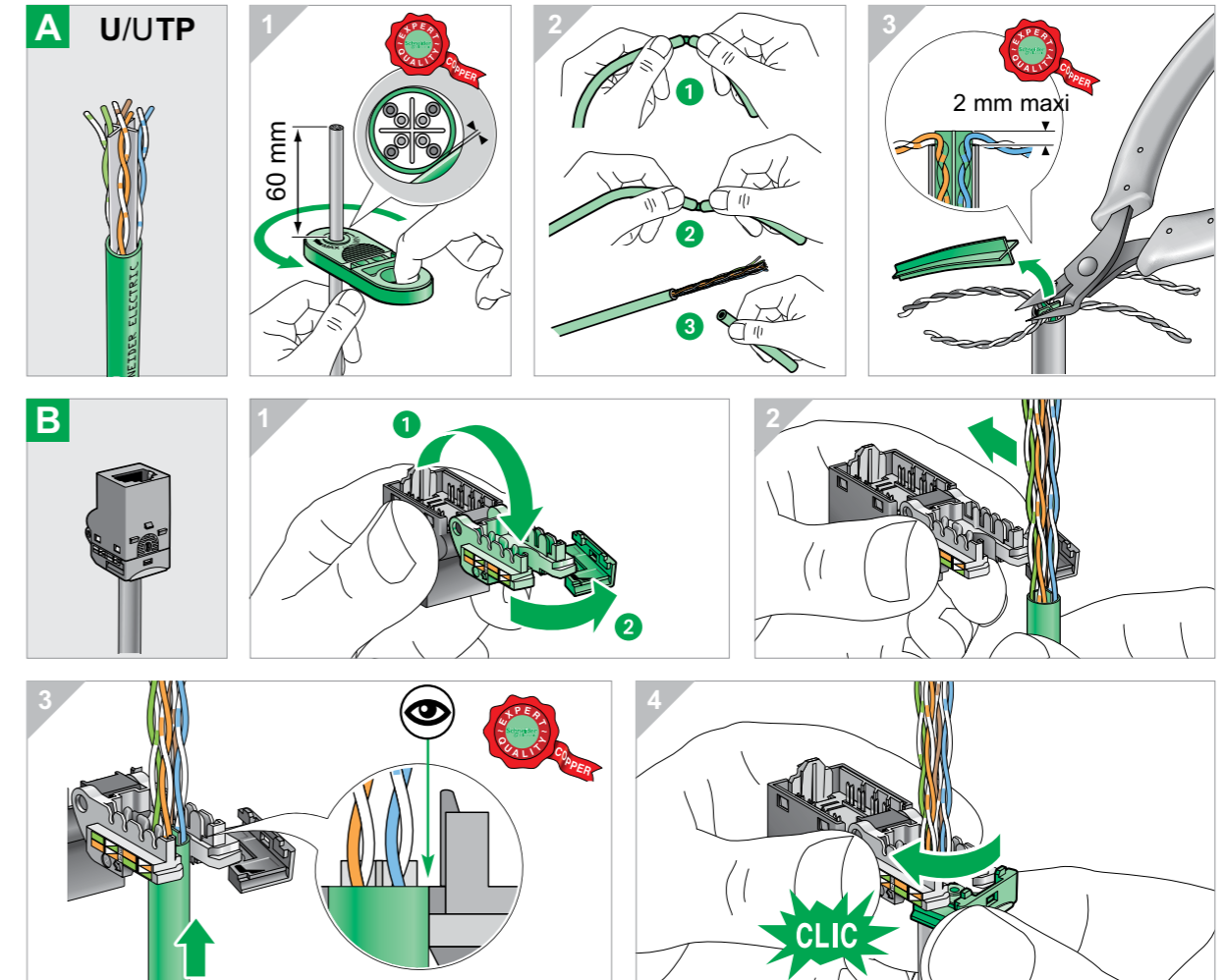

RJ45 data sockets (cont'd)

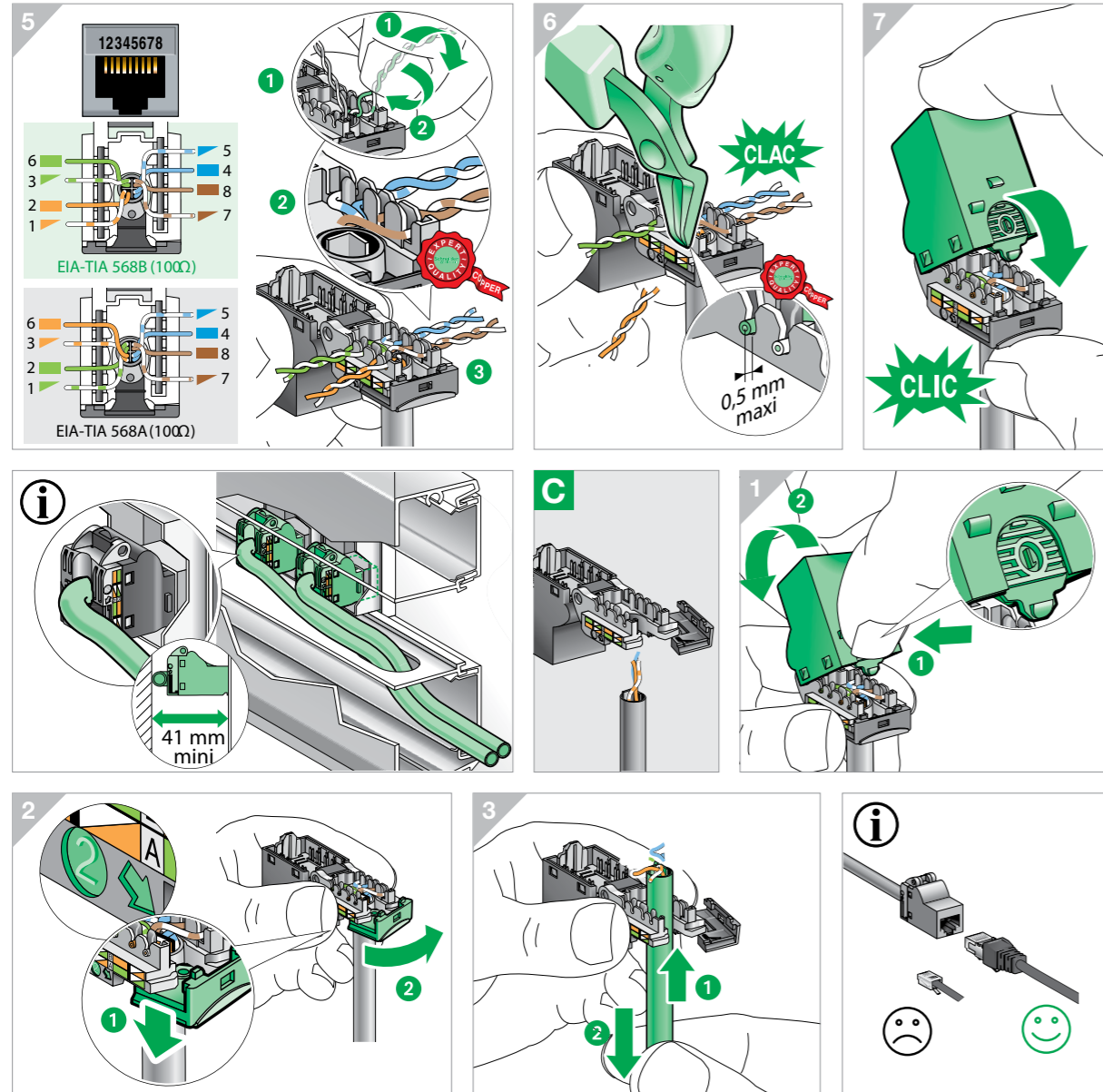

TV/R/SAT outlets

Area of application

Antenna sockets are adapted for connection of radio and television receivers, with land-based or satellite-based analog and digital signals.

Installation

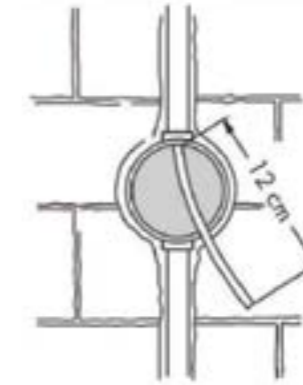

Dimensions (mm)

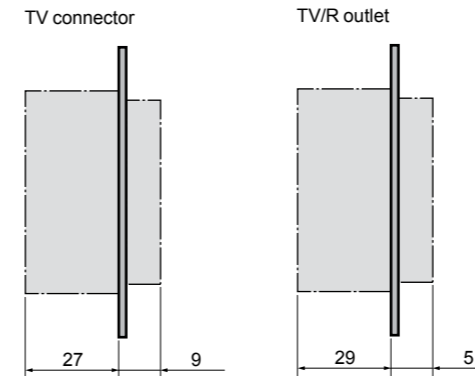

TV/SAT outlet
TV/R/SAT outlet
R-TV/SAT/SAT outlet

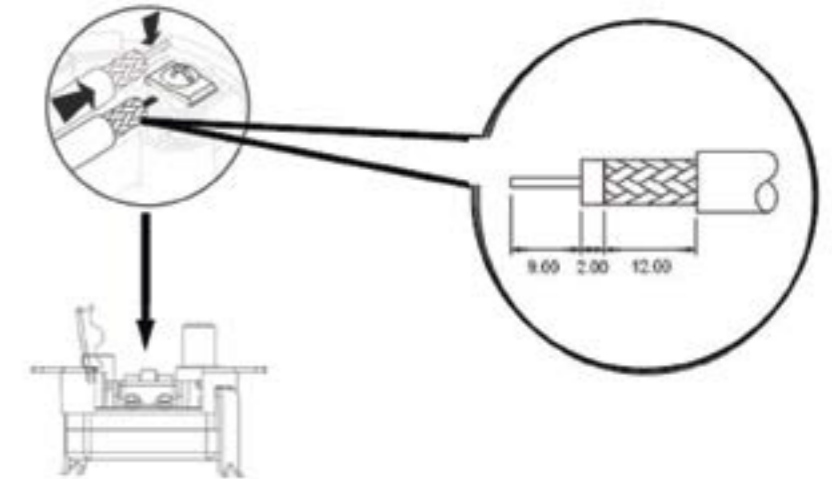
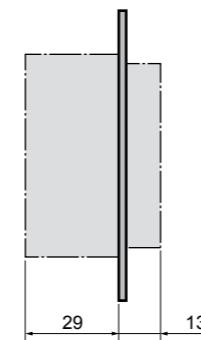

TV/R/SAT outlets

TV: individual / parallel installation insert

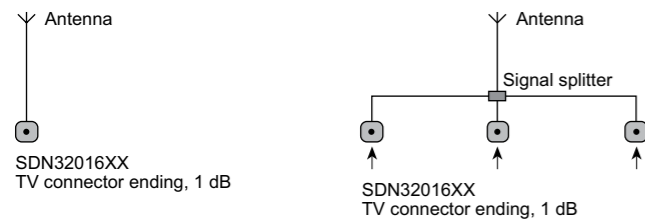

TV/R: individual / parallel installation insert

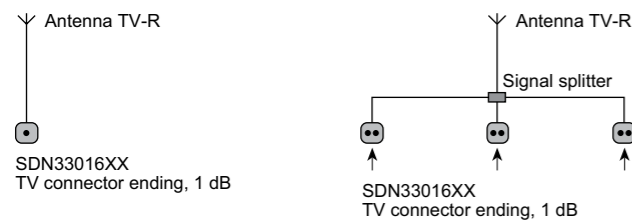

TV/R: linear installation insert

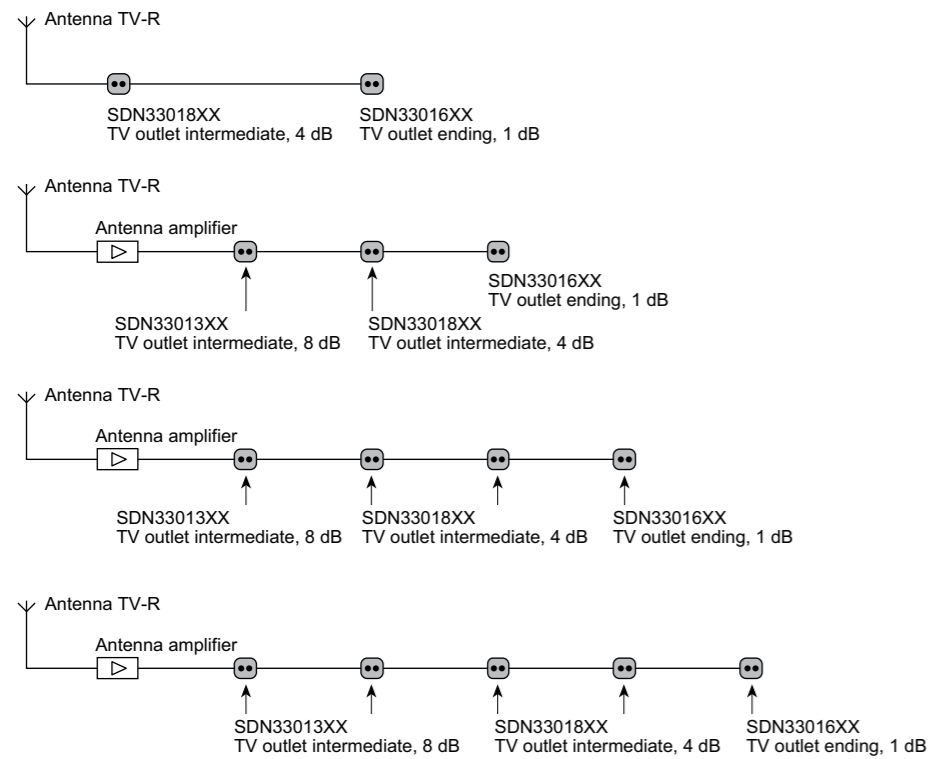

TV/SAT: individual / linear installation insert

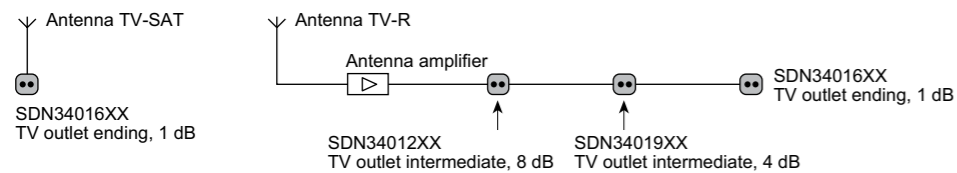

TV/R/SAT outlets

Connections

TV connector, intermediate TV connector, ending

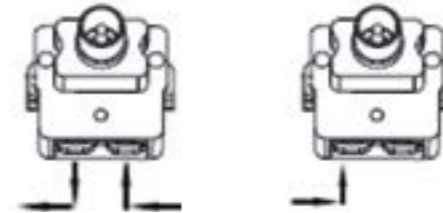

TV/R outlet, intermediate TV/R outlet, ending

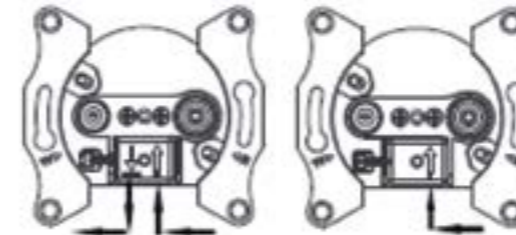

TV/SAT outlet, intermediate TV/SAT outlet, ending

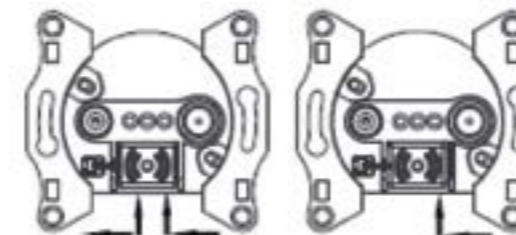

TV/R/SAT outlet, intermediate TV/R/SAT outlet, ending

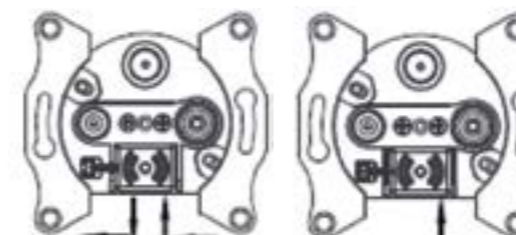

TV/SAT/SAT outlet, ending

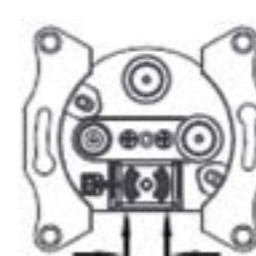

Technical data

TV connector

| | SDN32018XX Intermediate | SDN32012XX Intermediate | SDN32016XX Ending |
|---------------------------|----------------------------|----------------------------|----------------------|
| Loss (dB) | - | - | - |
| Operating frequency (MHz) | 5-862 | 5-862 | 5-862 |
| Output loss (dB) | 4 | 8 | 1 |
| Through loss (dB) | - | - | - |

TV/R outlets

| | SDN33018XX Intermediate | SDN33013XX Intermediate | SDN33016XX Ending |
|---------------------------|----------------------------|----------------------------|----------------------|
| Loss (dB) | 4 | 8 | - |
| Operating frequency (MHz) | TV 5-862 R 88-125 | 5-862 88-125 | 5-862 88-125 |
| Output loss (dB) | TV 4 R 10 | 8 10 | 1 10 |
| Through loss (dB) | 1 | 1 | - |

TV/SAT outlets

| | SDN34019XX Intermediate | SDN34012XX Intermediate | SDN34016XX Ending |
|---------------------------|----------------------------|----------------------------|----------------------|
| Loss (dB) | 4 | 8 | - |
| Operating frequency (MHz) | SAT 950-2400 TV 5-862 | 950-2400 5-862 | 950-2400 5-862 |
| Output loss (dB) | SAT 3 TV 4 | 3 8 | 1 1 |
| Through loss (dB) | 1 | 1 | - |

TV/R/SAT outlets

| | SDN35014XX Intermediate | SDN35012XX Intermediate | SDN35013XX Ending |
|---------------------------|--------------------------------------|-----------------------------|-----------------------------|
| Loss (dB) | 4 | 8 | - |
| Operating frequency (MHz) | SAT 950-2400 TV 5-862 R 88-125 | 950-2400 5-862 88-125 | 950-2400 5-862 88-125 |
| Output loss (dB) | SAT 3 TV 4 R 10 | 3 8 10 | 1 1 10 |
| Through loss (dB) | 1 | 1 | - |

TV/SAT/SAT outlets

| | SDN35021XX Ending |
|---------------------------|--|
| Loss (dB) | - |
| Operating frequency (MHz) | SAT1 5-2400 SAT2 950-2400 TV 5-862 |
| Output loss (dB) | SAT1 1 SAT2 1 TV 1 |
| Through loss (dB) | - |

Horizontal surface mounting Boxes

Multi gang

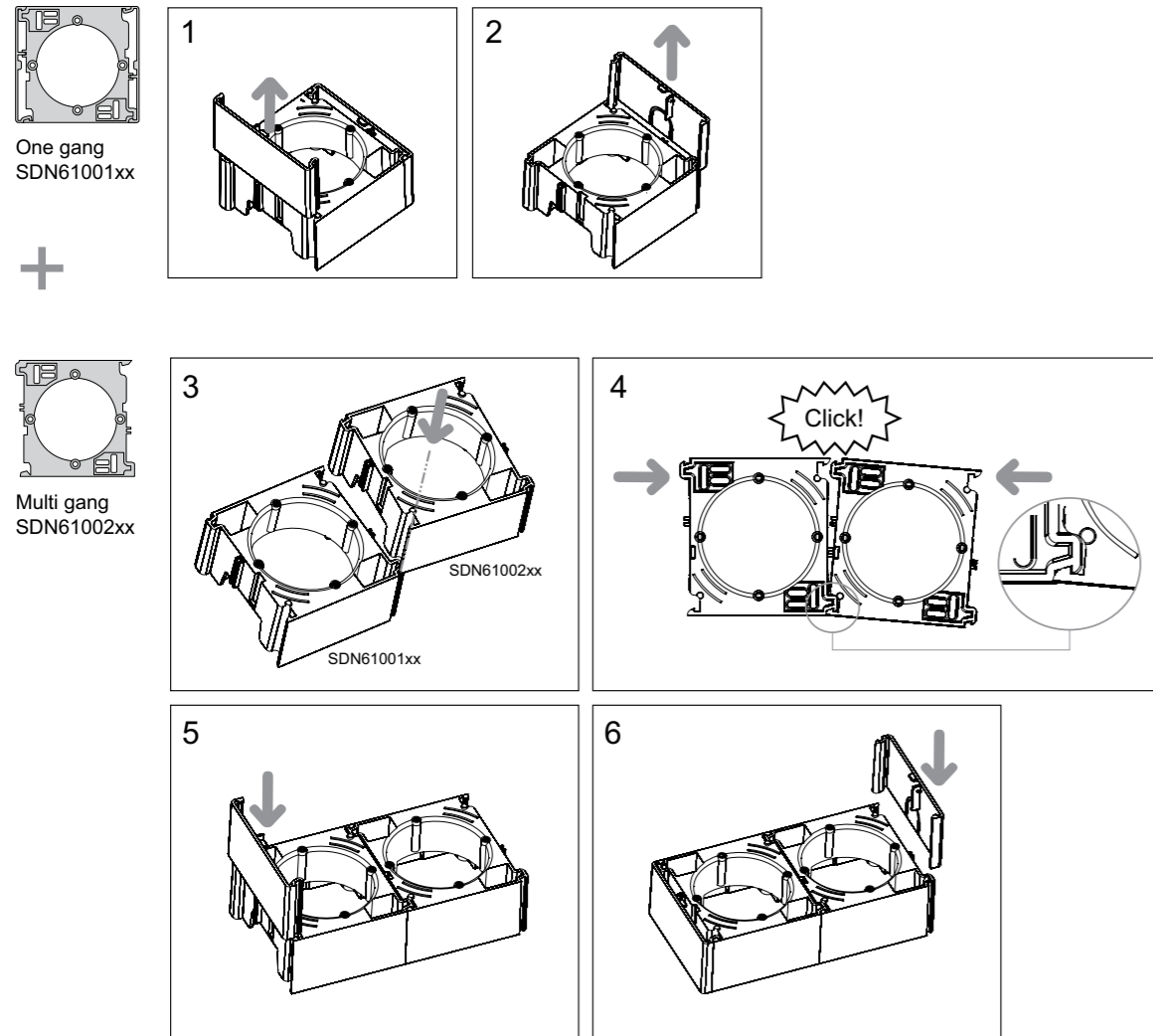

For TV/R, TV/SAT or TV/R/SAT outlets

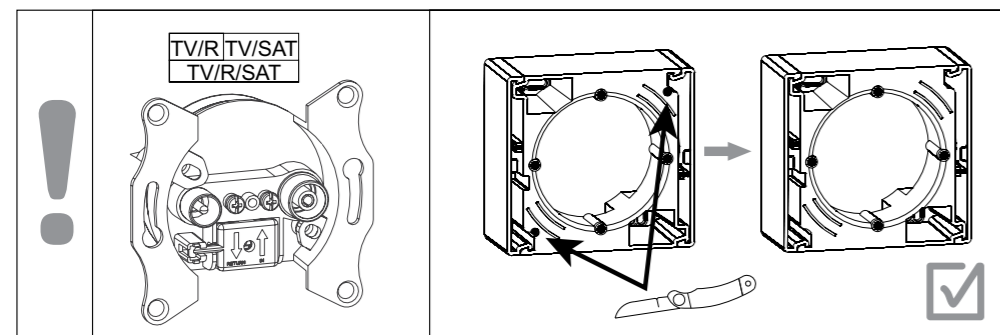

Cover frames dimensions (mm)

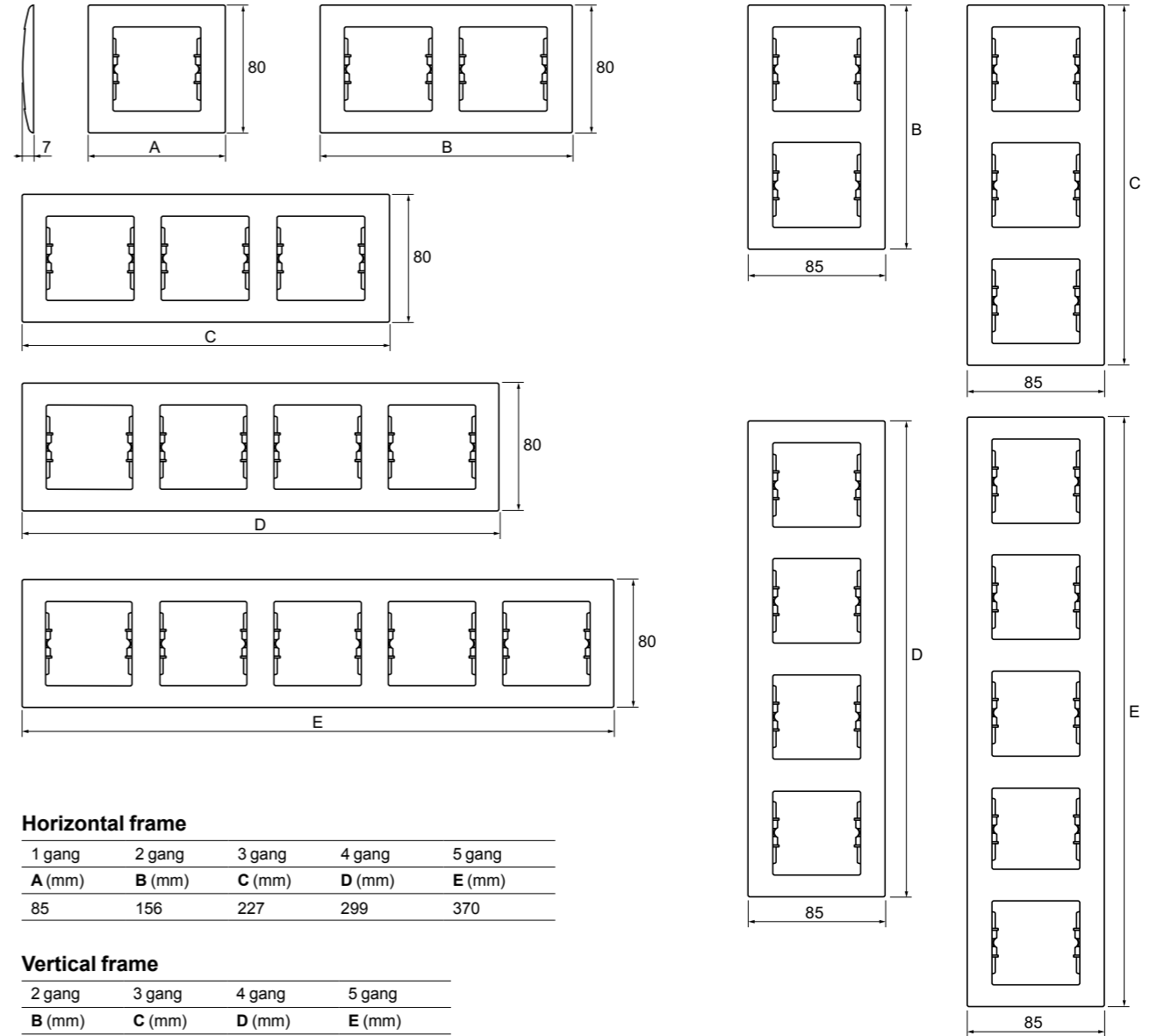

1 gang IP44 frame for IP44 switch or IP20 socket-outlet

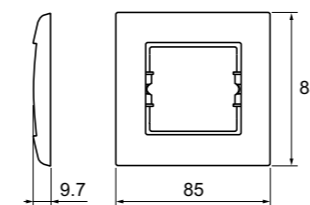

2 gang IP44 frame for IP44 switch or IP20 socket-outlet

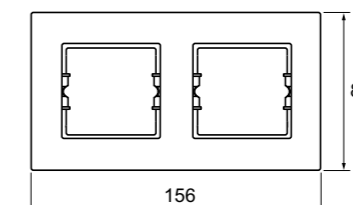

3 gang IP44 frame for IP44 switch or IP20 socket-outlet

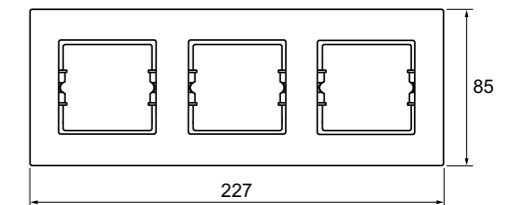

Reference number overview

| Ref | Pages | Ref | Pages |
|------------|-------|------------|-------|
| SDN5800160 | 34 | SDN5802023 | 34 |
| SDN5800168 | 34 | SDN5802033 | 34 |
| SDN5800170 | 34 | SDN5802041 | 34 |
| SDN5800321 | 34 | SDN5802047 | 34 |
| SDN5800323 | 34 | SDN5802060 | 34 |
| SDN5800333 | 34 | SDN5802068 | 34 |
| SDN5800341 | 34 | SDN5802070 | 34 |
| SDN5800347 | 34 | SDN5810521 | 34 |
| SDN5800360 | 34 | SDN5810523 | 34 |
| SDN5800368 | 34 | SDN5810547 | 34 |
| SDN5800370 | 34 | SDN5810560 | 34 |
| SDN5800521 | 34 | SDN5810568 | 34 |
| SDN5800523 | 34 | SDN5810570 | 34 |
| SDN5800533 | 34 | SDN5810621 | 34 |
| SDN5800541 | 34 | SDN5810623 | 34 |
| SDN5800547 | 34 | SDN5810647 | 34 |
| SDN5800560 | 34 | SDN5810660 | 34 |
| SDN5800568 | 34 | SDN5810668 | 34 |
| SDN5800570 | 34 | SDN5810670 | 34 |
| SDN5800721 | 34 | SDN5810721 | 34 |
| SDN5800723 | 34 | SDN5810723 | 34 |
| SDN5800733 | 34 | SDN5810747 | 34 |
| SDN5800741 | 34 | SDN5810760 | 34 |
| SDN5800747 | 34 | SDN5810768 | 34 |
| SDN5800760 | 34 | SDN5810770 | 34 |
| SDN5800768 | 34 | SDN5900123 | 31 |
| SDN5800770 | 34 | SDN6000121 | 25 |
| SDN5800921 | 35 | SDN6000123 | 25 |
| SDN5800923 | 35 | SDN6000147 | 25 |
| SDN5800933 | 35 | SDN6000160 | 25 |
| SDN5800941 | 35 | SDN6000168 | 25 |
| SDN5800947 | 35 | SDN6000170 | 25 |
| SDN5800960 | 35 | SDN6000321 | 25 |
| SDN5800968 | 35 | SDN6000323 | 25 |
| SDN5800970 | 35 | SDN6000347 | 25 |
| SDN5801121 | 34 | SDN6000360 | 25 |
| SDN5801123 | 34 | SDN6000368 | 25 |
| SDN5801133 | 34 | SDN6000370 | 25 |
| SDN5801141 | 34 | SDN6001121 | 25 |
| SDN5801147 | 34 | SDN6100121 | 33 |
| SDN5801160 | 34 | SDN6100123 | 33 |
| SDN5801168 | 34 | SDN6100147 | 33 |
| SDN5801170 | 34 | SDN6100160 | 33 |
| SDN5801321 | 34 | SDN6100168 | 33 |
| SDN5801323 | 34 | SDN6100170 | 33 |
| SDN5801333 | 34 | SDN6100221 | 33 |
| SDN5801341 | 34 | SDN6100223 | 33 |
| SDN5801347 | 34 | SDN6100247 | 33 |
| SDN5801360 | 34 | SDN6100260 | 33 |
| SDN5801368 | 34 | SDN6100268 | 33 |
| SDN5801370 | 34 | SDN6100270 | 33 |
| SDN5801521 | 35 | | |
| SDN5801523 | 35 | | |
| SDN5801533 | 35 | | |
| SDN5801541 | 35 | | |
| SDN5801547 | 35 | | |
| SDN5801560 | 35 | | |
| SDN5801568 | 35 | | |
| SDN5801570 | 35 | | |
| SDN5802021 | 34 | | |

Life Is On



Schneider Electric Industries SAS

35, rue Joseph Monier
CS 30323
92506 Rueil Malmaison Cedex
France

RCS Nanterre 954 503 439
Capital social 928 298 512 €
www.se.com

July, 2020
Sedna catalogue

© 2020- Schneider Electric. All Rights Reserved.
All trademarks are owned by Schneider Electric Industries SAS or its affiliated companies.
ISC01548EN

This document has been
printed on recycled paper

