

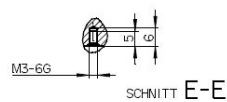

| | |
|--------------------------------------|--------------------------------------|
| Samenstelling | Basiselement met centrale afdekplaat |
| Uitvoering | Enkel drukcontact |
| Contacten | 1 maakcontact |
| Montagewijze | Inbouw (stucwerk) |
| Materiaal | Metaal |
| Kwaliteitsklasse | Aluminium |
| Oppervlaktebescherming | Geen (onbehandeld) |
| Kleur | Aluminium |
| Geschikt voor beschermingsgraad (IP) | IP54 |
| Halogeenvrij | Ja |
| Nom. spanning | 250Volt |

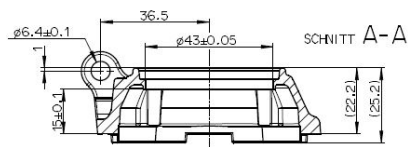
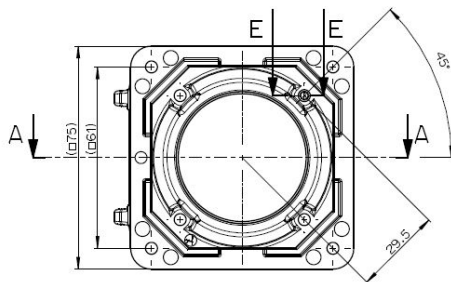

| | |
|-------------------------------|-------------------------------|
| Algemeentolerantie nach | |
| Feinlektrom 500882 D2 | |
| Zukunftsige Abweichungen fuer | |
| Lerngruppen (Werte in mm) | |
| 0.5 | +5 -30 -100 -400 |
| -8 | -30 -100 -400 -1000 |
| ±0.10 | ±0.20 ±0.30 ±0.50 ±0.80 |

| Material No. | Article No. | EAN-code |
|--------------|---------------------|---------------|
| 00906294 | D 324/6.69 T AGU WE | 4010105906295 |

PEHA Elektro GmbH & Co. KG

a Honeywell Company
Gartenstraße 49
58511 Lüdenscheid
Deutschland

Telefon +49 (0)2351 87979 00
Telefax +49 (0)2351 87979 92
peha@honeywell.com
www.peha.de

Änderungen vorbehalten. © Honeywell PEHA