





## Installation and operating instructions

### D 451 FU-BEP DAB

Easyclickpro LED flush-mounted dimmer receiver

#### 1. Safety



**WARNING!**  
**Danger due to a failure to observe the instructions.**

These instructions contain important information for the safe handling of the device. Potential dangers are specifically highlighted. Failure to observe this information can lead to death or serious injury.

- Read the instructions through carefully.
- Observe the safety information in these instructions.
- Store the instructions in an accessible location.



**WARNING!**  
**Risk of electric shock.**

A failure to observe the ambient conditions can lead to dangerous situations when working with current. The device contains current-carrying parts. Contact with live parts can lead to electric shock, burns or death.

- Power off the electrical system before installation.
- Secure the electrical system against being powered on again.
- Check that the device is powered off.
- Close housing before switching on.
- Protect the device against moisture.
- Make sure that cables are not damaged, kinked or crushed.
- Observe the mains voltage.
- Make sure that the mains supply is suitable.
- Protect supply line with circuit breakers (F = max. 16 A).

#### 1.1 Intended use

The device is intended for the following use only:

- Radio LED trailing-edge phase dimmer for dimming a connected load for a specific time.
- Installation in ø 58 mm flush mounting box.
- Only suitable for dimmable 230 V LED lamps or incandescent/halogen lamps.

Use only when in technically faultless condition and after correct installation with approved faceplate. Intended use also includes reading and observing these instructions.

#### 1.2 Authorised target groups

Mounting, installation and fault diagnostics by qualified electricians exclusively. Requirements:

- Knowledge of the basics of electrical engineering.
- Knowledge of the national regulations and standards.
- Knowledge of the applicable health & safety and accident prevention provisions.
- Knowledge of these instructions.

Operation and disposal by the user. Requirements:

- Knowledge of these instructions.

#### 1.3 General safety information

In the following cases, use of the device is prohibited:

- In case of damage to the device or individual components.
- In case of unauthorised modifications or changes to the device.
- For children and persons who are unable to assess the dangers of handling the device.

In the following cases, the manufacturer accepts no liability for damage:

- With a failure to observe these instructions.
- With non-intended use.
- With use by unauthorised target groups.
- With the use of spare parts, that have not been manufactured or approved by the manufacturer.
- Use in conjunction with hazardous devices.
- If the safety equipment on the device has been bypassed.

Further safety information is provided in the respective relevant sections of these instructions.

#### 2. Product

The LED flush-mounted dimmer receiver belongs to the Easyclickpro System from PEHA.

- Radio (868.3 MHz, EnOcean).
- Bi-directional function (transmit/receive).
- Energy measurement.
- Repeater function can be activated.
- Function of the receiver can be adjusted for every radio transmitter.
- Unlimited number of receivers per transmitter.
- Input for wired push-buttons (230 V) (for additional one-touch dimming with conventionally wired push-buttons).
- Trailing edge phase dimming.

Figure: D 451 FU-BEP DAB

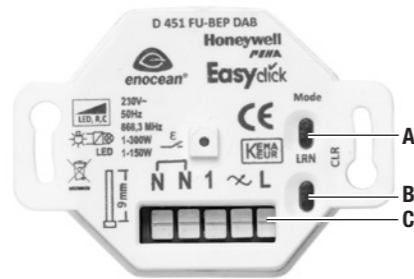

- A MODE button
- B LRN button
- C Connection terminals

Technical information	
Own consumption	Standby < 0.5 W
Transmission frequency	868.3 MHz
Technology	Trailing edge phase dimmer
Nominal voltage	230 V~ +/-10% / 50 Hz
Input voltage at the button input	230 V~ +/-10% / 50 Hz
Fuse	Circuit breaker with max. 16 A
Ambient temperature	0 °C to 40 °C
Storage temperature	-40 °C to 85 °C
Ambient humidity	< 85 % RH
Plug-in terminals	max. 1 x1.5 mm <sup>2</sup>
Test specifications	EN 60669 IEC/EN 62368 EN 55015 EN 61547 EN 61000 EN 301489 EN 62479 EN 300 220
Protection class	IP 20
Neutral conductor	Required
Energy measurement accuracy	+/- 5%

Load types	230 V~
Incandescent lamps	300 W
HV halogen lamps	300 W
Dimmable 230 V LED lamps	150 W
Minimum load	1 W

The device fulfils:

- Directive 2014/30/EU (EMC directive)
- Directive 2014/35/EU (low voltage directive)
- Directive 2014/53/EU (radio equipment directive)
- Directive 2011/65/EU (RoHS)
- Directive 2002/96/EG (WEEE)
- Ordinance EC 1907/2006 (REACH)



#### 3. Radio range

Radio signals are electromagnetic waves. The field strength at the receiver decreases with increasing distance from the transmitter. The radio range is therefore limited. The radio range is further reduced by various materials or sources of interference in the direction of propagation of the radio signals. Through the use of Easyclickpro Repeaters (radio amplifiers) it is possible to increase the radio range.

➔ "8.13 EnOcean-Repeater function"

Material	Reduction
Wood, plaster, uncoated glass	0 - 10 %
Masonry, timber/plaster walls	5 - 35 %
Reinforced concrete	10 - 90 %

Range	Conditions
> 30 m	Good conditions (large open space, free of obstacles).
> 20 m	Through up to 5 plasterboard / drywall or 2 brick / aerated concrete walls (Furniture and people in the room): – For transmitters and receivers with good antenna position/version.
> 10 m	Through up to 5 plasterboard / drywall or 2 brick / aerated concrete walls (Furniture and people in the room): – For receivers installed in the wall or corner of the room. – For receivers with internal antenna or in narrow corridors.
Through 1-2 ceilings / walls	Dependent on the reinforcement of the ceiling/wall and the antenna version of the receiver.

#### Note

Further information on the subject of "radio range" is available on the internet at "www.peha.de".

#### 4. ENOCEAN Equipment Profiles (EEP)

The EnOcean EEPs are standardised communication profiles. They facilitate communication with various products from different manufacturers.

The table below is intended for specialist personnel who require the communication profiles for a project with PEHA products:

EEP	Status feedback
A5-11-01	Lighting controller
A5-11-04	Extended lighting status
D2-01-00	Electronic switches and dimmers with local control

EEP	Communication profiles	Function	Mode
A5-38-09	Extended lighting control	-	-
D2-01-00	Electronic switches and dimmers with local control	-	-
F6-02-01	Push button	1	1
F6-04-01	Key card activated switch (hotel key card switch)	1	1
A5-07-01	PIR sensor	7	4
A5-07-03	PIR sensor	7	4
A5-08-01	PIR sensor	7	4
A5-06-xx	LUX sensor	7	4

#### Note

After assigning a new radio transmitter in the learning mode of the receiver, the function and mode of the radio transmitter are already pre-set as standard.

#### 5. Installation

##### 5.1 Safety information for installation

- All work on the supply network and device must be performed by qualified electricians.
- Observe the applicable laws and regulations of the country in which the device is operated.
- Observe the current state of technology at the time of installation.
- The provisions of these instructions, with the specifications of the electrical system, are to be observed.



**CAUTION!**  
**Danger of damage due to incorrect installation.**

Incorrect installation can destroy the device.

- Only mount the device in a faultless condition.
- Use suitable fastening material.
- Before final installation in the false ceiling, all Easyclickpro transmitters to be used should already be taught and programmed with the desired function.
- Only install in a permissible installation environment.
- ➔ "5.2 Installation environment"

##### 5.2 Installation environment

The following situations must be avoided with the installation environment:

- Never install the receiver in a metal enclosure or in close proximity to large metal objects.
- Do not install the receiver close to floor level or on the floor.
- The receiver is not suitable for electronic transformers that are approved for phase angle control dimming.
- The receiver is not suitable for inductive loads (e.g. conventional transformers or motors).
- Observe the permitted load types and max. load.
- ➔ "2. Product"

##### 5.3 Installation

- Make sure the electrical system is powered off.
- Make sure the connected load corresponds with the installation situation.
- Install the flush mounting box in a suitable location.
- Connect the device in accordance with the circuit diagram.
- Insert the device in the flush mounting box and screw tight.
- Switch on the electrical system.
- Assign the radio transmitters (max. 32) to the receiver.
- ➔ "6. Programming"

##### Circuit diagram

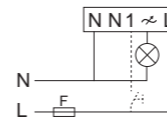

Dimmer (Easyclickpro)

#### 6. Programming

##### Information on programming

- To perform programming, the receiver must be connected to the supply network. In the event of a power failure, the programming is retained.
- Observe the operating instructions for the radio transmitter.
- The radio transmitters (max. 32) must be assigned to the receiver in learning mode before use. No radio transmitter is assigned at the time of delivery.
- In learning mode it is possible to assign or delete multiple radio transmitters. With multiple activation, they are alternately assigned or deleted.
- Programming is automatically ended after 30 s if no buttons are pressed.

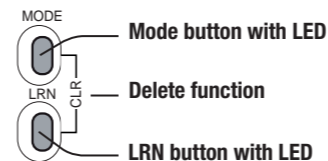

##### 6.1 Learning mode

Assign or delete transmitters.

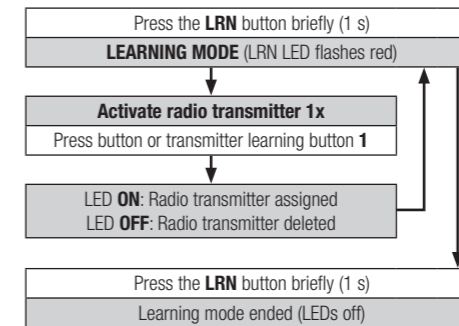

When assigning radio transmitters in learning mode, the standard functions are assigned:

➔ "4. ENOCEAN Equipment Profiles (EEP)"

##### 6.2 Delete function

Delete all assigned transmitters.

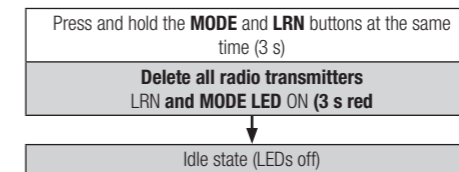

##### 6.3 Function programming

Set function and mode.

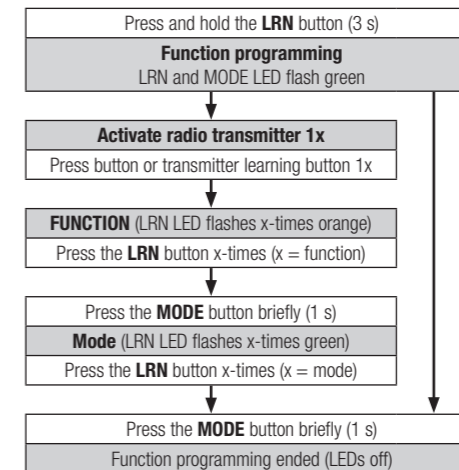

#### 7. Example of programming

##### Assign or delete radio transmitters

LRN	Press the LRN button briefly (1 s): <b>LRN LED flashes red (learning mode)</b>
LRN	Press the O or I button on the radio transmitter.
LRN	<b>LRN LED on</b> Radio transmitter assigned. <b>LRN LED off</b> Radio transmitter deleted. <b>LRN LED continues flashing after 3s</b>
LRN	Press the LRN button briefly (1 s): LED off (learning mode ended).

##### Set function 3 and mode 2

LRN	Press and hold the LRN button (3 s).
LRN MODE	<b>LRN and MODE LED flash green</b>
LRN	Press the O or I button on the radio transmitter.

##### Set function 3 and mode 2

LRN	<b>LRN LED flashes x-times orange (x = function)</b> Press the LRN button 3x. = function 3.
MODE	Press the MODE button briefly (1 s).
LRN	<b>LRN LED flashes x-times green (x = mode)</b> Press the LRN button 2x. = mode 2.
MODE	Press the MODE button briefly (1 s): LED off. (Function programming ended.)

#### 8. Functions

There are two variants of dimmer control:

- Manual control via a locally wired button.
- Remote control via an EnOcean radio transmitter with radio signal.

Before use, the transmitters must be taught their assignment to the receiver (max. 32 transmitters).

After teaching a wall-mounted transmitter, function 1 of the receiver is pre-set. It can be changed in the radio programming. Each transmitter can actuate an unlimited number of receivers.

##### 8.1 General functions

Function	Description
Memory	The current dimming value is stored.
Soft start	When switching on, the lighting is dimmed up to the stored dimming value (memory).

##### 8.2 Easyclickpro radio transmitter

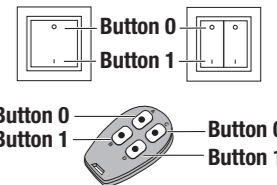

Easyclickpro wall-mounted transmitter and radio control

##### 8.3 Function 1

(two-button operation with memory)

Wall-mounted transmitter	Function
Press the I button briefly.	Switch on with soft start.
Press the O button briefly.	Switch off with memory.
Press and hold the I button.	Dim the lighting brighter.
Press and hold the O button.	Dim the lighting darker.
Press and hold the button/release.	Dimming process stops (memory).

##### Note

Standard function after teaching a wall-mounted transmitter!









