

SMART [3] PLUS EMERGENCY

GEWISS

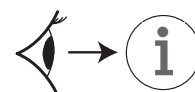

IP65



$t_{min} \pm 5^{\circ}C$



	t_a
SMART [3] 1200-1600	40°C
SMART [3] HLO 1600	

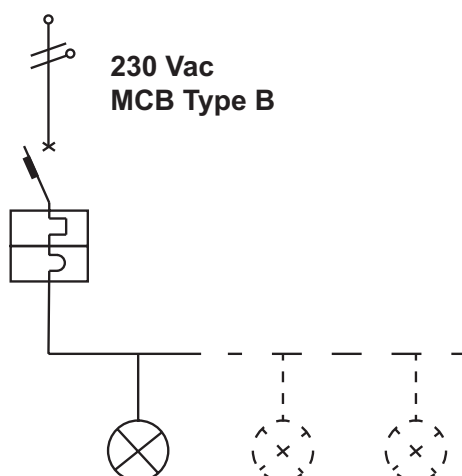

MCB current	max no. SMART [3]		
	10 A	16 A	20 A
SMART [3] 1200-1600	18	29	35
SMART [3] HLO 1600	11	18	22

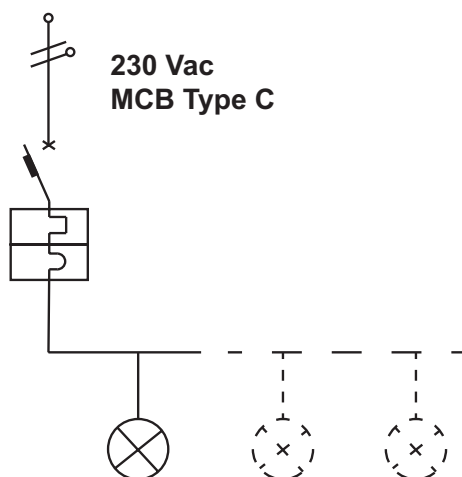





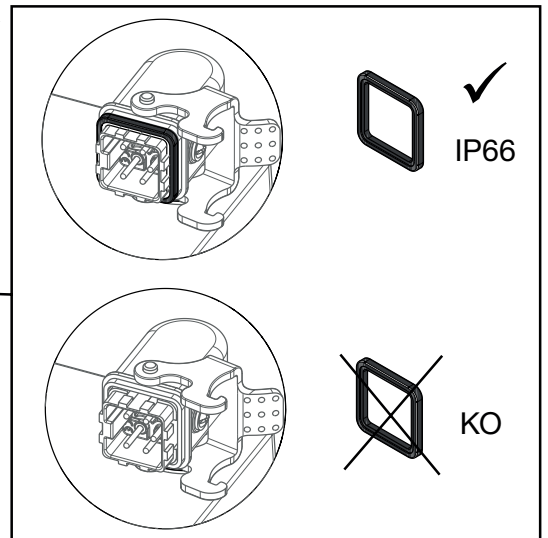
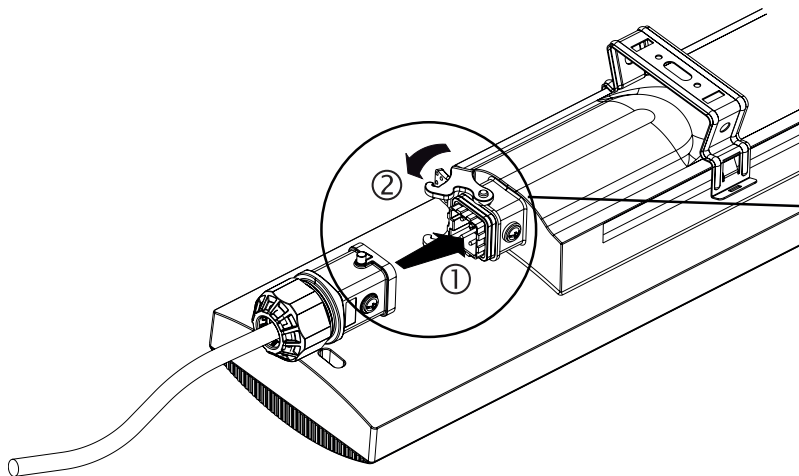
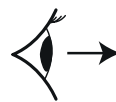
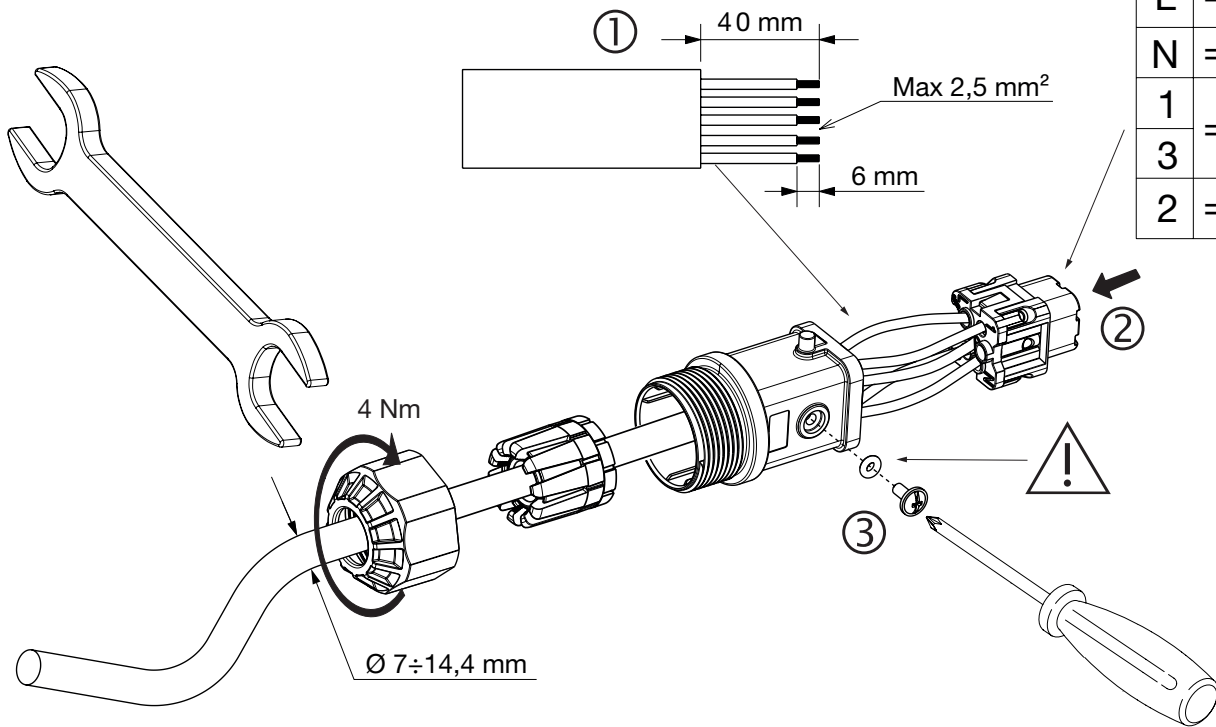

MCB current	max no. SMART [3]		
	10 A	16 A	20 A
SMART [3] 1200-1600	30	49	60
SMART [3] HLO 1600	18	30	37

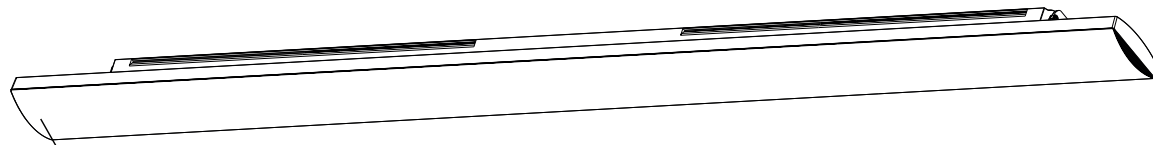
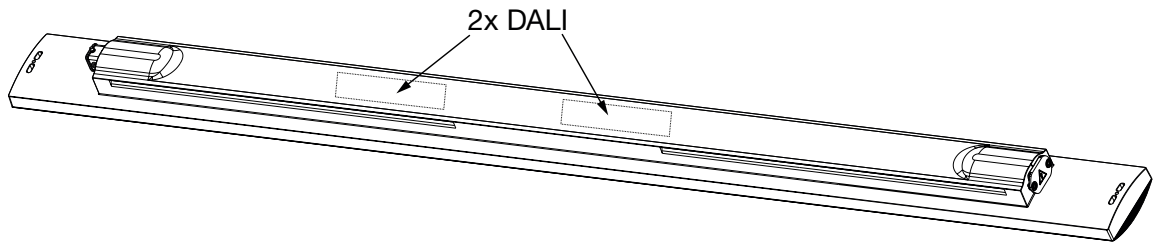

L	=	L
N	=	N
1	=	DALI
3	=	DALI
2	=	L
		UNSWITCHED





	☀	GREEN	AC 
	●	OFF	DC 
	☀ 0,1s ● 0,1s	GREEN	FUNCTION TEST
	☀ 1s ● 1s	GREEN	DURATION TEST
	☀ ● ☀ ●	GREEN	INHIBIT MODE
	☀	RED	KO 
	☀ 0,1s ● 0,1s	RED	KO 
	☀ 1s ● 1s	RED	KO 
	☀ ● ☀ ●	RED/ GREEN	DALI ADDRESS

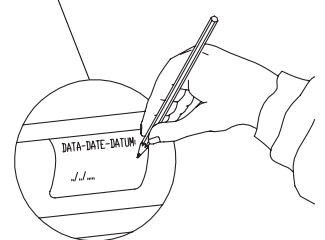
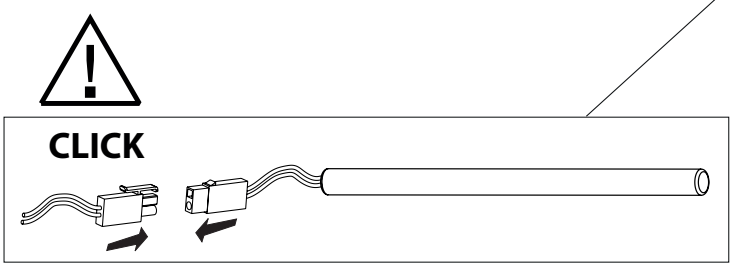
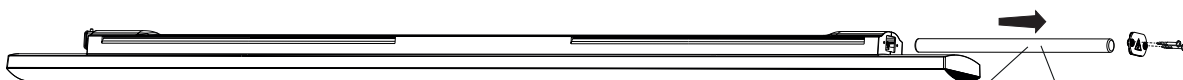

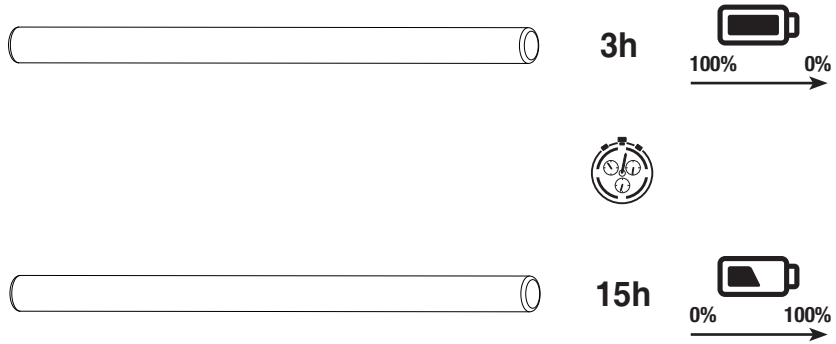

		Φ				
		CRI 80		CRI 90		
			4000K 5700K 6500K	3000K	4000K 5700K 6500K	3000K
	P 3h	3,2V 7,5Ah LiFePO4	630 lm	600 lm	500 lm	460 lm
	P 3h	3,2V 7,5Ah LiFePO4	550 lm	520 lm	430 lm	410 lm
	P 3h	3,2V 7,5Ah LiFePO4	550 lm	520 lm	430 lm	410 lm

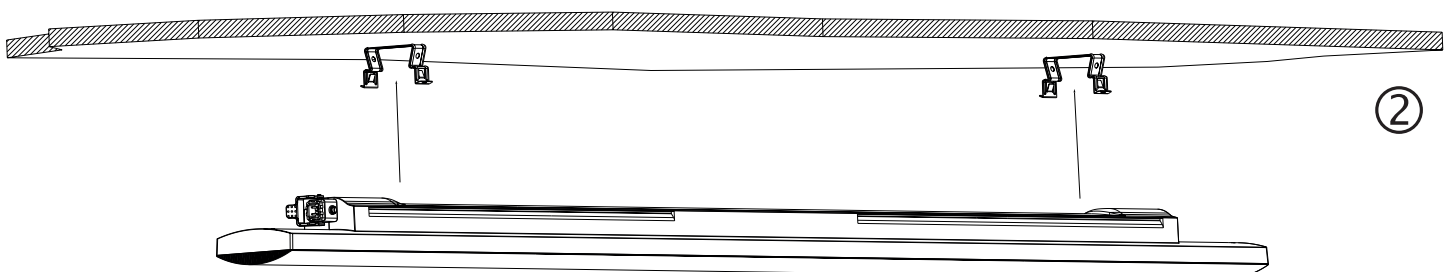
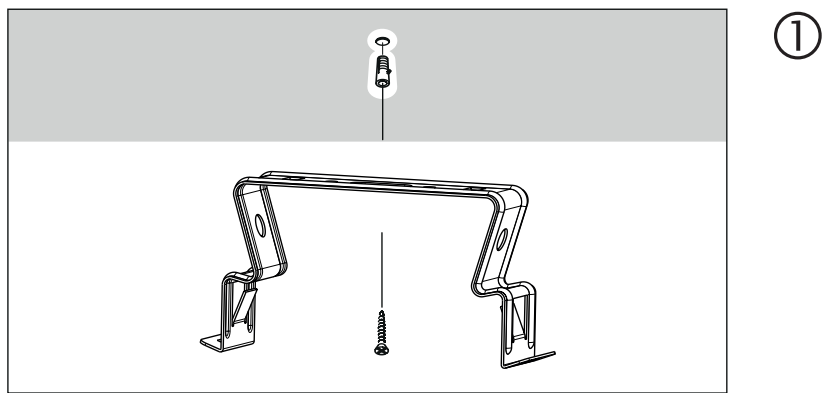

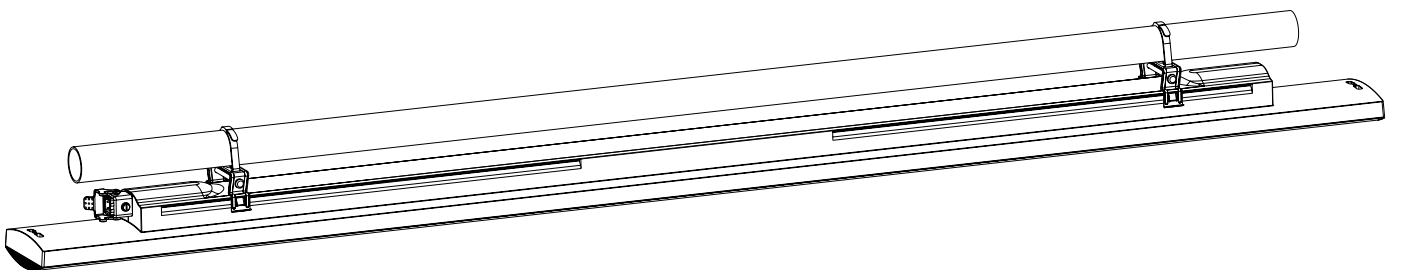
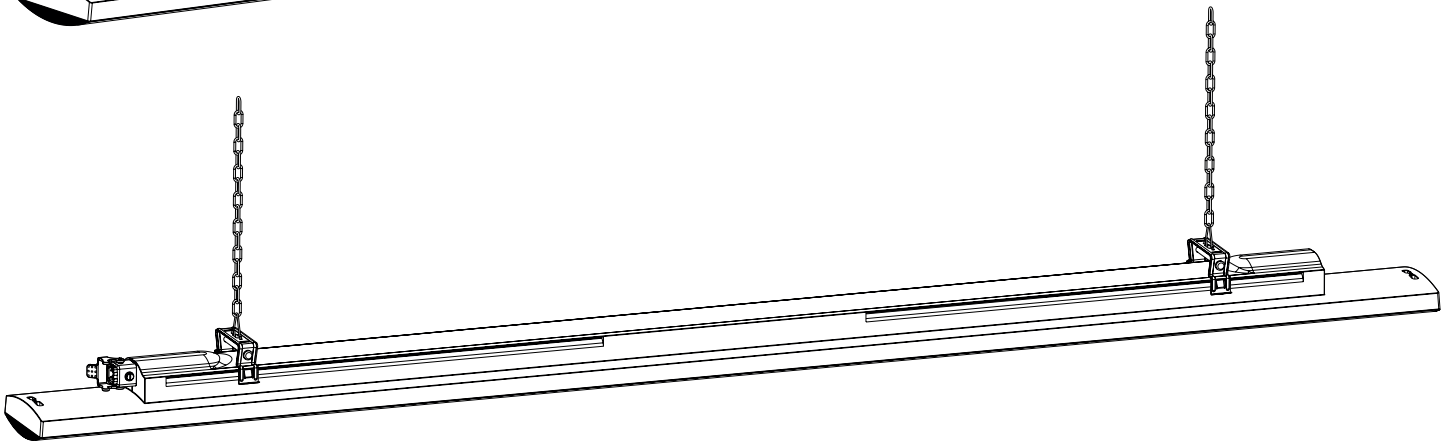
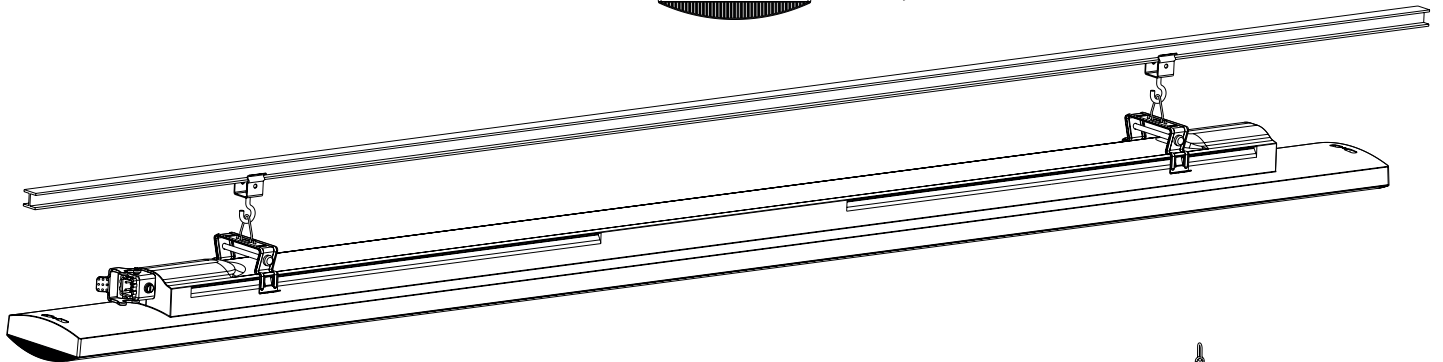
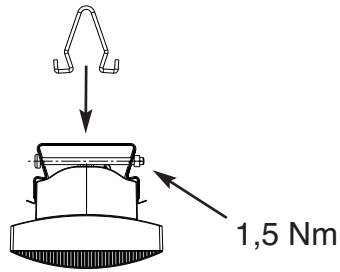
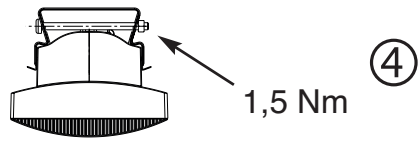
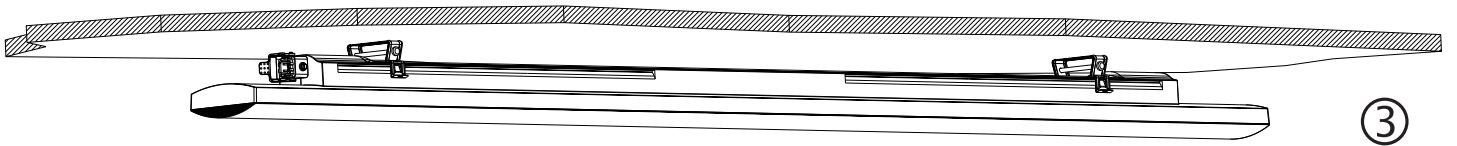

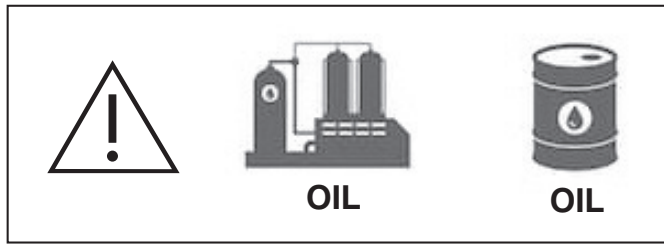

OK! ✓

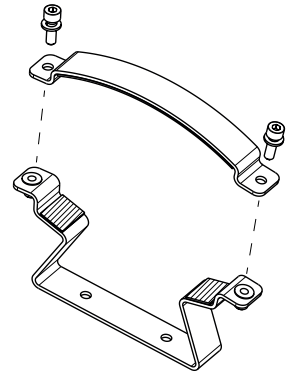
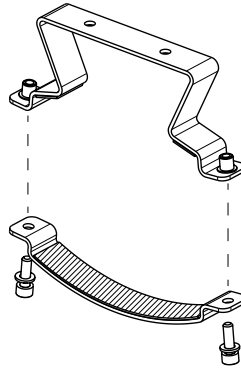
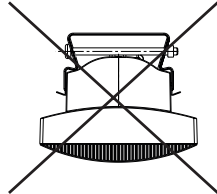
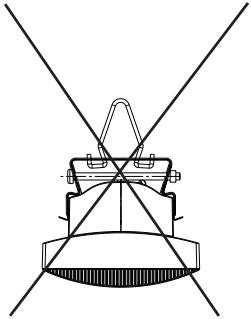

GWS3296

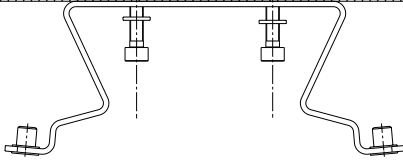
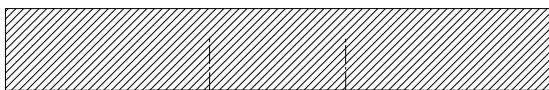

①

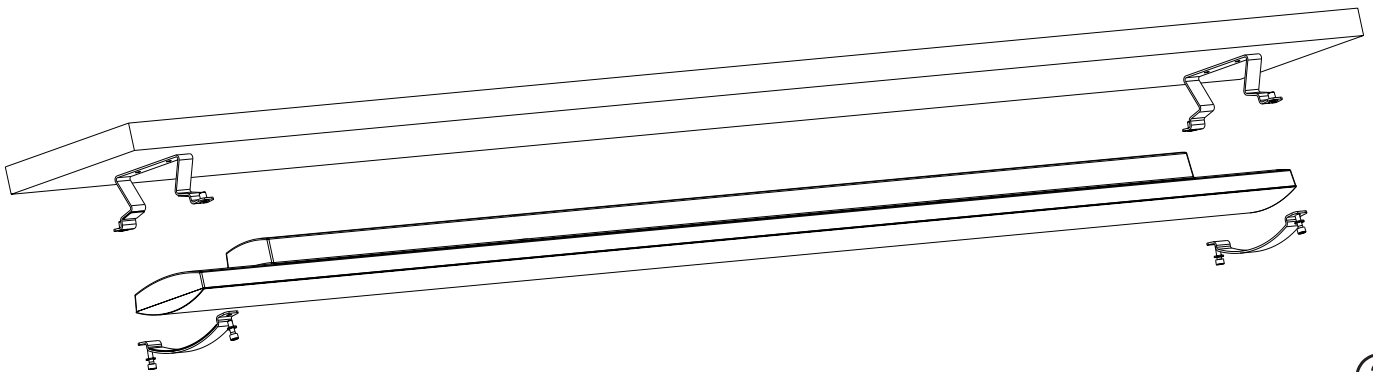

②

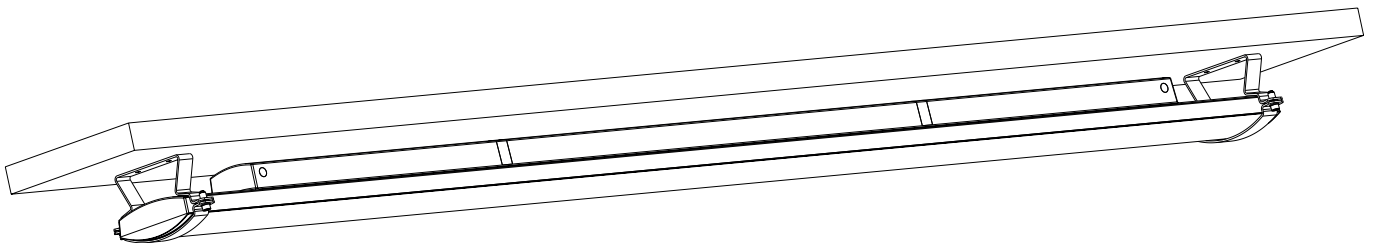

③



④

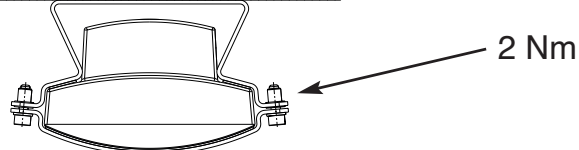

2 Nm

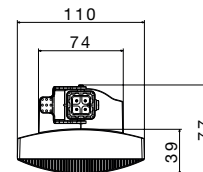
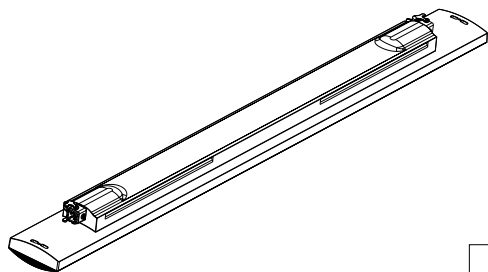
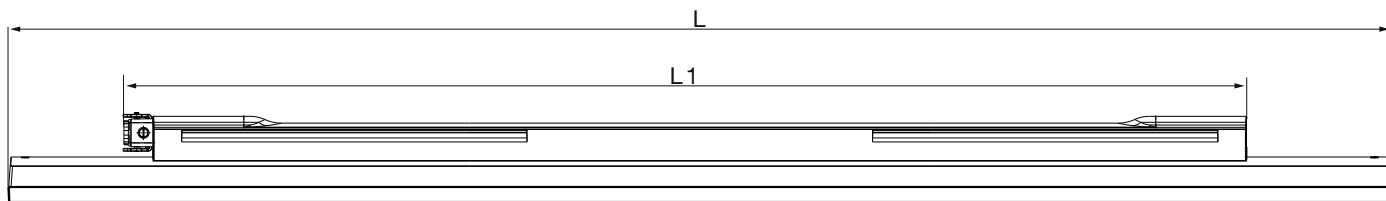

	L	L1
SMART [3] 1200	1200	970
SMART [3] 1600	1600	1370



GWS3296

GWS3194

GWS3191

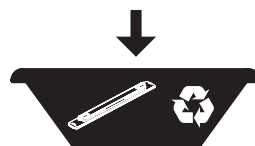
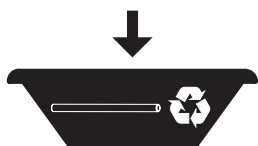
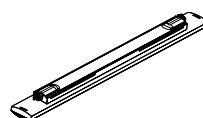
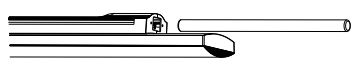
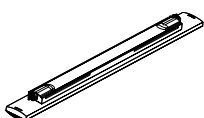
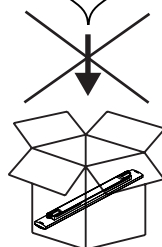
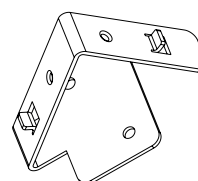
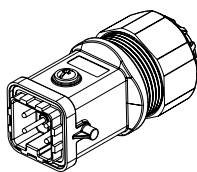
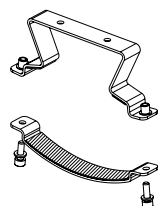

Punto di contatto indicato in adempimento ai fini delle direttive e regolamenti UE applicabili:
Contact details according to the relevant European Directives and Regulations:

GEWISS S.p.A. Via A.Volta, 1 IT-24069 Cenate Sotto (BG) Italy tel: +39 035 946 111 E-mail: qualitymarks@gewiss.com



+39 035 946 111

8.30 - 12.30 / 14.00 - 18.00
lunedì - venerdì - monday - friday



+39 035 946 260



sat@gewiss.com
www.gewiss.com