

Product Data Sheet

GW10674

CHORUSMART - Domestic range

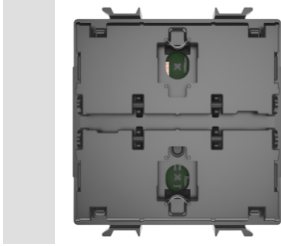

Flush-mounting axial dimmer module. Two axial push-buttons on the front for switching the connected load ON and OFF (short press) or for regulating the brightness (long press). The device must be completed with one of the front buttons key available. The device has N°3 DIP-switches, located on the back of the device, for feature configuration.

Description	Dimmer Assiale	Power supply	100 ÷ 240 V ac - 50/60 Hz
No. modules	2	No. input channels	2
Local control	Via 2 front push buttons (to complete with button key)	Auxiliary input channel voltage	100 ÷ 240 V ac - 50/60 Hz
Stocking temperature	-25 ÷ +70 °C	N. canali ingresso LED	-
Working temperature	-5 ÷ +45 °C	Tensione canali ingressi LED	-
Relative humidity (non-condensative)	Max 93%	No. output channels	1
Front light signaling	Blue led	Output contacts	-
Wiring terminals	With screw	240 V ac Incandescent-halogen lamps	4-150 W
Terminal tightening capacity stranded cables (mm ²)	Max. 1,5	240 V ac LED lamps	4 ÷ 150W (max 5 lampade)
Terminal tightening capacity solid cables (mm ²)	Max. 1,5	Loads piloted from electronic transformers 240 V ac	4 ÷ 150 VA (240 V ac)
Context	Interno, luoghi asciutti	240 V Fluorescent lamps	-
IP degree	IP20 (with button key)	Load control	Trailing edge
Standard	2014/35/EU (LVD), 2014/30/EU (EMC), 2011/65/EU + 2015/863 (RoHS), EN 60669-2-1, EN 60669-1, EN 300 328, EN IEC 63000		

DIMENSIONAL

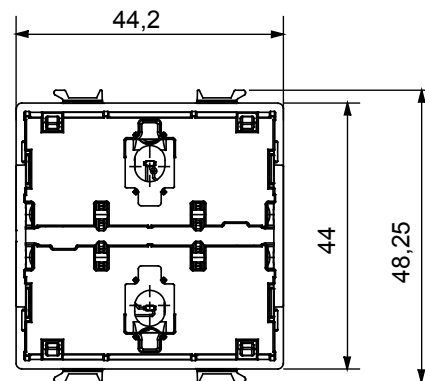
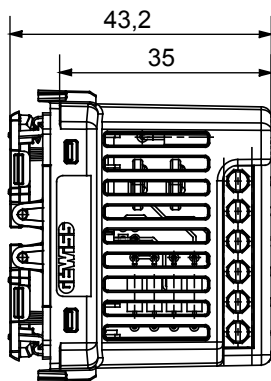

TECHNICAL SYMBOLOGY

IP

IP20 (with button key)

STANDARDS/APPROVALS



GEWISS S.p.A. Via A. Volta, 1
24069 Cenate Sotto - Bergamo - Italy
tel. +39 035 94 61 11 fax +39 035 94 69 09

www.gewiss.com
sat@gewiss.com
Last update 20/04/2023

Data, measures, designs and pictures are shown only as informative purposes, and could be changed without previous notice