

Relay universal insert

Operating instructions

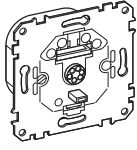

Art. -no. MTN575897

For your safety



DANGER

Risk of fatal injury from electrical current.

All work on the device should only be carried out by qualified electricians. The country-specific regulations must be followed.



DANGER

Risk of fatal injury from electrical current.

The output may carry an electrical current even when the load is switched off. Always disconnect the fuse in the incoming circuit from the supply before working on connected loads.

Universal relay insert introduction

With the universal relay insert you can switch ohmic, inductive or capacitive loads (incandescent lamps, 230-V halogen lamps, NV-halogen lamps with wound transformer, loads with electronic transformer) by using a sensor cover.

You can choose from three operation modes:

- "Push-button function" operating mode
- "Time function" operating mode
- "Switch function" operating mode

You can connect up to ten extension TELE inserts (Art.-no. MTN573998). You can also connect any number of mechanical extension units (conventional push-buttons).

Relay universal insert components

Complete the universal relay insert with a frame and a

- Sensor cover (Art. no. MTN5776..., MTN5701..., MTN5737..) or
- TELE sensor cover (Art. no. MTN5779..., MTN5703..., 5709..) or
- Control electronics, 1-gang (Art. no. MTN569090) and glass sensor cover (Art. no. MTN569x..)

Setting the operating mode

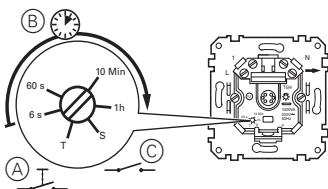

- (A) Push-button function operating mode
- (B) Time function operating mode
- (C) Switch function operation mode

Push-button function operating mode

When set to this operation mode, the universal relay insert switches the load on when the button is pushed and off when the button is released:

- ① Set the trimmer to position "S" (left-hand stop (A)).

Time function operating mode

When set to this operating mode, the universal relay insert switches "On" when the button is pushed and automatically switches "Off" when the time period set has elapsed.

As soon as the timer function is started, the button is disabled for five seconds. During this time, the insert will ignore any further engagement of the button.

When the block time has elapsed, you can terminate the timer function by pressing the button again (before the set time has elapsed); the insert will switch to "Off". You can set an "on" time of between six seconds and one hour.

- ① Set the trimmer to a position (B) between "6 s" and "1 h", depending on the "on" time required.

Switch function operation mode

In this operating mode, the universal relay insert switches between "on" and "off" every time the button is pressed. This operating mode is useful for room lighting, for example (on-off switch).

- ① Set the trimmer to position "S" (right-hand stop (C)).

Relay universal insert installation



DANGER

Risk of fatal injury from electrical current.

The output may carry an electrical current even when the load is switched off. Always disconnect the fuse in the incoming circuit from the supply before working on connected loads.

- ① Wire the universal relay insert for the required application:

Application:

- Individual universal relay single:

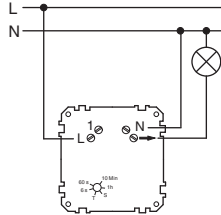

- Two universal relay inserts (any number) connected in parallel. The load is switched on or off when one of the universal relay inserts switches:

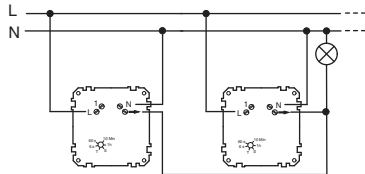

- Universal relay insert (A) in extension unit operation with mechanical push-button (B) (any number) and/or electronic extension unit (C) (max. of ten).

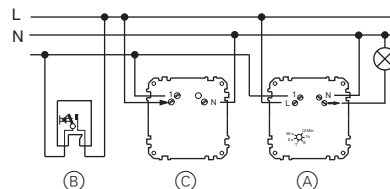

A neutral conductor **is required**.

- ② Install the universal relay insert in the socket-outlet so that the anti-twist adapter is at the bottom.

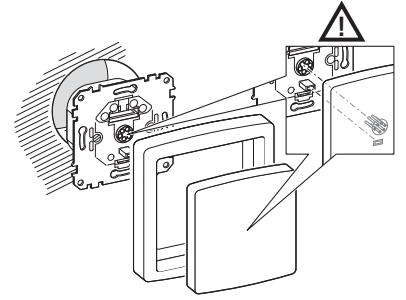

- ③ Make sure the required operating mode has been set (see "Set operating mode").



CAUTION

Bending the contact pins

The contact pins on the rear of the sensor cover can become bent if tilted excessively. Therefore always plug the sensor cover in as straight as possible.

- ④ Attach the accompanying sensor cover together with the frame. Hold the sensor cover so that the recess at the back is at the bottom to receive the pin of the push-button insert.

For glass sensor covers: refer to the accompanying installation instructions.

Relay universal insert operation

Lightly touching the sensor operating surface generates a current pulse. The pulse duration is independent of the duration of the sensor contact.



Replace the fuse



DANGER

Risk of fatal injury from electrical current.

Switch off the mains voltage.

- ① Pull the fuse holder out to the front and replace the fuse (A) (replacement fuse (B)).

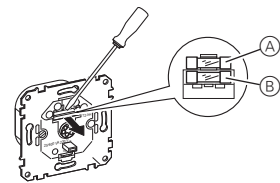

Technical data

Mains voltage:	AC 220 – 230 V, 50/60 Hz
Switching capacity:	
Incandescent lamps:	1000 W
230 V halogenlamps:	1000 W
NV halogen lamps:	500 VA
Motors:	500 W
Capacitive load:	140 µF
Neutral conductor:	Required
Short-circuit protection:	G - Fuse insert T 5.0 H
Operating modes:	Push-button function (left-hand stop)
	Switch function (right-hand stop)
	Time function (6 s - 1 h)

Schneider Electric Industries SAS

If you have technical questions, please contact the Customer Care Center in your country.
www.schneider-electric.com

This product must be installed, connected and used in compliance with prevailing standards and/or installation regulations. As standards, specifications and designs develop from time to time, always ask for confirmation of the information given in this publication.