

PRODUCT DATASHEET

LN UO 1500 60 W 3000 K

LINEAR ULTRA OUTPUT | Surface luminaire with high luminous flux



Areas of application

- Direct replacement for luminaires with fluorescent lamps
- Indoor applications
- Industrial and commercial halls
- Public areas
- Corridors, stairwells, basements

Product benefits

- Replacement of conventional T8 luminaires with up to 7100 lm
- Energy savings up to 60 % (compared to luminaires that use fluorescent lamps)
- Robust structure with IK08
- 5 years guarantee

Product features

- Very high luminous efficacy: up to 125 lm/W
- Robust metal housing and PC diffusor
- Wiring at back side of luminaire
- Through wiring possible



TECHNICAL DATA**Electrical data**

Nominal wattage	60.00 W
Nominal voltage	220...240 V
Mains frequency	50...60 Hz
Nominal current	300 mA
Inrush current	50 A
Inrush current time T_{h50}	100 μ s
Max. no. of lum. on circuit break. B16 A	17
Max. no. of lum. on circuit break. C10 A	13
Max. no. of lum. on circuit break. C16 A	22
Power factor λ	> 0.90
Total harmonic distortion	\leq 15 %
Protection class	I
Operating mode	Integrated LED driver

Photometrical data

Luminous flux	6600 lm
Luminous efficacy	110 lm/W
Color temperature	3000 K
Light color (designation)	Warm White
Color rendering index Ra	\geq 80
Standard deviation of color matching	\leq 5 sdc _m
Photobiological safety group acc. to EN62778	RG0
Beam angle	110 °

Dimensions & Weight

Length	1458.00 mm
Width	62.00 mm
Height	74.00 mm
Product weight	1850.00 g



Materials & Colors

Product color	White
Housing color	White
Body material	Steel
Cover material	Polycarbonate (PC)
Light emitting surface material	Polycarbonate (PC)
Glow Wire Test according to IEC 60695-2-12	650 °C
Mercury content	0.0 mg

Application & Mounting

Ambient temperature range	-10...+40 °C
Type of connection	Screwless terminal
Type of protection	IP20
Protection class IK (shock resistance)	IK08
Dimmable	No
Mounting type	Surface
Mounting location	Ceiling / Wall
Application environment	Indoor
LED module replaceable	Not replaceable
With light source	Yes

Lifespan

Lifespan L70/B50 at 25 °C	50000 h
Lifespan L80/B10 at 25 °C	40000 h
Lifespan L90/B10 at 25 °C	30000 h
Number of switching cycles	100000

Certificates & Standards

Standards	CE / CB / ENEC / TÜV SÜD / EAC
Luminaire with limited surface temperature, "D sign"	No

Ball shot safe	No
----------------	----

Additional product data

Number of illuminants	-
-----------------------	---

EQUIPMENT / ACCESSORIES

- Mounting screws and dowels included

DOWNLOAD DATA

DOWNLOAD DATA



User instruction



Addon Technical Information



Tender documents



Declarations Of Conformity CE



On-Pack-Info



IES file (IES)



LDT file (Eulumdat)



R3D file (Relux 3D Model)



M3D file (3D Model)



ULD file (DIALux)



UGR file (UGR table)

LOGISTICAL DATA

Product code	Packaging unit (Pieces/Unit)	Dimensions (length x width x height)	Gross weight	Volume
4058075122260	Folding box 1	69 mm x 1,464 mm x 77 mm	1950.00 g	7.78 dm ³
4058075122277	Shipping box 6	1,474 mm x 225 mm x 170 mm	13360.00 g	56.38 dm ³

The mentioned product code describes the smallest quantity unit which can be ordered. One shipping unit can contain one or more single products. When placing an order, for the quantity please enter single or multiples of a shipping unit.

ADDITIONAL CATALOG INFORMATION

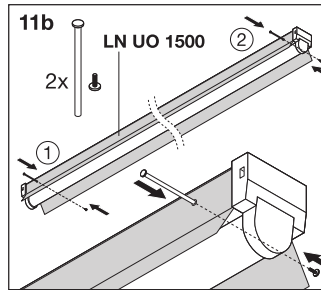
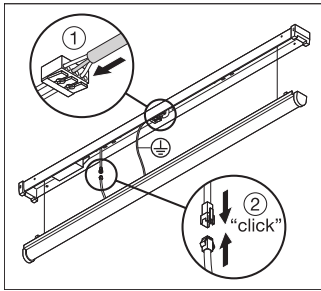

References / Links

- For Guarantee see www.ledvance.com/guarantee

DISCLAIMER

Subject to change without notice. Errors and omission excepted. Always make sure to use the most recent release.